



VENUE	FEES SAT-SUN	FEES WEEKDAYS	DAMAGE DEPOSIT
Greer Social Hall • 4,800 sq ft • Capacity for banquets with a dance floor: 299 • White Dance Floor: 28 ft by 24 ft; Stage: 50 ft W by 20 ft D	\$5600	\$4600	\$1500
Corwin Family Sanctuary & Greer Social Hall Night Party with dividing wall • 8,400 sq ft • capacity for banquets: 299	\$6600	\$5600	\$1500
Corwin Family Sanctuary & Greer Social Hall without Dividing Wall • 8,400 sq ft • capacity for banquets: 299-550 • Price incrementally increases due to guest count • Draping of bima required • Beige chairs removed	0-299 \$7,000 300-350 \$8,000 351-400 \$8,500 401-450 \$9,000 451-500 \$9,500 501-550 \$10,000	0-299 \$6,000 300-350 \$7,000 351-400 \$7,500 401-450 \$8,000 451-500 \$8,500 501-550 \$9,000	\$1500

Included in the package:

- 299-550 silver Chiavari chairs (depends on package)
- 30-55 round 60 inch tables (depends on package)
- 20 rectangular 8 ft tables and 20 rectangular 6 ft tables
- 7 high-top and 7 low-top cocktail tables
- 2 serpentine / sweetheart tables
- white dance floor - 28 ft by 24 ft (may be made smaller)
- courtyard - an outdoor space (weather permitting)
- foyer - often used for cocktails and appetizers
- bride's and groom's suites
- state-of-the-art kitchen
- 2 security guards
- 2 lobby restroom attendants
- 2 facilities staff
- 1 house manager on duty

Agreement Terms:

- 50% non-refundable down-payment and a signed contract
- damage deposit may be fully or partially refunded following facility inspection and based on contract terms
- draping of Bima required with wall-up packages
- valet parking using Abraham's Valet, our only approved valet service
- if guest count exceeds 299, advance coordination with the Beverly Hills Fire Marshal is also required
- weekday events: 6:30 pm - 12:00 midnight (5 & 1/2 hour rental)
- weekend events: 6:00 pm - 12:00 midnight (6 hour rental)
- extended event hours until 1:30 am: \$1500 surcharge
- All event rentals require permits from the City of Beverly Hills



VENUE	FEES SAT-SUN	FEES WEEKDAYS	DAMAGE DEPOSIT
Greer Social Hall • 4,800 sq ft • Capacity for banquets with a dance floor: 299	\$5600	\$4600	\$1500
Corwin Family Sanctuary & Greer Social Hall with Dividing Wall (Ceremony & Reception) • 8,400 sq ft • capacity for banquets: 299	\$6600	\$5600	\$1500
Corwin Family Sanctuary & Greer Social Hall without Dividing Wall • 8,400 sq ft • capacity for banquets: 299-550 • Price incrementally increases due to guest count • Draping of bima required • Beige chairs removed	0-299 \$7,000 300-350 \$8,000 351-400 \$8,500 401-450 \$9,000 451-500 \$9,500 501-550 \$10,000	0-299 \$6,000 300-350 \$7,000 351-400 \$7,500 401-450 \$8,000 451-500 \$8,500 501-550 \$9,000	\$1500
Add-on of Chuppah (optional)	\$100	\$100	
Add-on of Belle Chapel (Small Ceremony or Ketubah Signing) (Optional—Greer Social Hall booking required)	\$500	\$500	

Included in the package:

- 299-550 silver Chiavari chairs (depends on package)
- 30-55 round 60 inch tables (depends on package)
- 20 rectangular 8 ft tables and 20 rectangular 6 ft tables
- 7 high-top and 7 low-top cocktail tables
- 2 serpentine / sweetheart tables
- white dance floor - 28 ft by 24 ft (may be made smaller)
- courtyard - an outdoor space (weather permitting)
- foyer - often used for cocktails and appetizers
- bride's and groom's suites
- state-of-the-art kitchen
- 2 security guards
- 2 lobby restroom attendants
- 2 facilities staff
- 1 house manager on duty

Agreement Terms:

- 50% non-refundable down-payment and a signed contract
- damage deposit may be fully or partially refunded following facility inspection and based on contract terms
- draping of Bima required with wall-up packages
- valet parking using Abraham's Valet, our only approved valet service
- if guest count exceeds 299, advance coordination with the Beverly Hills Fire Marshal is also required
- weekday events: 6:30 pm - 12:00 midnight (5 & 1/2 hour rental)
- weekend events: 6:00 pm - 12:00 midnight (6 hour rental)
- extended event hours until 1:30 am: \$1500 surcharge
- All event rentals require permits from the City of Beverly Hills



VENUE	EVENT TYPE	FEES SAT-SUN	FEES WEEKDAYS	DAMAGE DEPOSIT
Greer Social Hall • Rental includes Foyer and Courtyard • 4,800 sq ft • capacity for banquets with a dance floor: 299	Bar/Bat Mitzvah Dinner Party	\$5600	\$4600	\$1500
Corwin Family Sanctuary & Greer Social Hall without Dividing Wall • 8,400 sq ft • capacity for banquets: 299-550 • Price incrementally increases due to guest count • Draping of bima required • Beige chairs removed	*Bar/Bat Mitzvah Dinner Party	0-299 \$7,000 300-350 \$8,000 351-400 \$8,500 401-450 \$9,000 451-500 \$9,500 501-550 \$10,000	0-299 \$6,000 300-350 \$7,000 351-400 \$7,500 401-450 \$8,000 451-500 \$8,500 501-550 \$9,000	\$1500

Included in the package:

- 299-550 x Silver Chiavari chairs (dependent on package)
- 30-55 x Round 5 ft tables (dependent on package)
- 20 x Rectangular 8 ft tables; 20 x Rectangular 6 ft tables
- 7 x High-top (cocktail) tables; 7 x Low-top tables;
- 3 Serpentine tables
- White dance floor - 28 ft by 24 ft
- Easel
- The courtyard - an outdoor space (weather permitting)
- Foyer - often used for cocktails and appetizers
- 2 Lounges / Dressing Rooms
- State-of-the-art kitchen
- 2 security guards
- 1 Day-of Venue Manager
- 2 Cleaning Staff
- 2 Maintenance Staff

Agreement Terms:

- 50% non-refundable down-payment and a signed contract
- damage deposit may be fully or partially refunded following facility inspection and based on contract terms
- draping of Bima required with wall-up packages
- valet parking using Abraham's Valet, our only approved valet service
- if guest count exceeds 299, advance coordination with the Beverly Hills Fire Marshal is also required
- weekday events: 6:30 pm - 12:00 midnight (5 & 1/2 hour rental)
- weekend events: 6:00 pm - 12:00 midnight (6 hour rental)
- extended event hours until 1:30 am: \$1500 surcharge
- All event rentals require permits from the City of Beverly Hills



VENUE	FEES SAT-SUN	FEES WEEKDAYS	DAMAGE DEPOSIT
Corwin Family Sanctuary & Greer Social Hall with dividing wall • 8,400 sq ft; Capacity 299	\$6500	\$6500	\$1500

Included in the Corwin Family Sanctuary & Greer Social Hall Memorial package:

- 299 silver Chiavari chairs in Greer Hall
- 299 beige armchairs in the Sanctuary
- round 60" dining tables
- rectangular 8 ft buffet tables
- high-top cocktail tables
- state-of-the-art kitchen
- security guards, restroom attendants, facilities staff

Agreement Terms:

- 100% non-refundable down-payment and a signed contract
- damage deposit may be fully or partially refunded following facility inspection and per contract terms
- valet parking is included using Abraham's Valet
- licensee pays 10% gratuity for valet parking based on parking rates
- 4-hour max rental
- weekday start time 6:30 pm or later
- weekend start time between 5:00 pm or later



ADDITION	FEE
Early Set up/Load in • Recommended for glatt kosher caterers. * • Please check availability with Special Events Manager. Schedule is in accordance with temple calendar.**	\$500 for 4 hours \$1000 for 8 hours
Late Pick Up/ Load Out • Please check availability with Special Events Manager. Schedule is in accordance with temple calendar.**	\$500
Change of Date Fee • Only available for rentals that are more than 4 months out.*	\$600
Chapel Rental • Capacity 50, only available as on add-on to a Greer Hall rental *	\$500
Sanctuary Rental • Capacity 299, auditorium seating, ideal for screenings & conferences	\$2900
Extended Party Hours • Party ends at 1:30 am (only available at time of contract signing)	\$1500



1. \$1500 Damage Deposit

Damage deposit may be refunded fully or partially based on an inspection of the facility following the event and per the following contract terms:

- physical damage noted by our house manager and photographed as documentation
- 20% penalty for late payments made beyond 3 days past the due dates specified in the contract
- \$150 fine for each late submission of required documents: vendor list, timeline, floorplan, & valet parking contract

2. Valet Parking

- Valet required per City of Beverly Hills
- Abraham's Valet Parking is our only valet parking service
- 818.334.7474, David@AbrahamsValet.com, www.AbrahamsValet.com

3. Beverly Hills Fire Department

- Permits—\$153 for basic public assembly permit, required for all events
- Permits: \$76.50 each for draping and candles if needed
- Fire Safety Officer—\$156 per hour (required for 300 guests or more)
- Permit and FSO fees are determined by the City and subject to change
- Confirm which permits you will need with the Fire Department
- Please begin this process no later than 1 month out from your event
- Apply for permits **on-line using the link we will provide**
- Prices set by the City and subject to change without notice

4. Draping of Bima for wall-up events: \$600



TIMELINE FOR BOOKING AN EVENT

Booking the venue (to secure date and venue)

- Sign contract
- Pay 50% of rental fee

60 days prior to event

- Remaining 50% of rental fee
- Sign valet parking contract and forward Temple a copy

30 days prior to event

- Apply for permits with City of Beverly Hills fire department
- Pay \$1500 damage deposit

14 days prior to event

- Submit floorplans to Temple
- Submit vendor list to Temple
- Submit timeline to Temple

7 days prior to event

- Provide Temple Emanuel with copy of completed permits from City of Beverly Hills.

Three to four weeks after event

- Damage deposit may be fully or partially refunded if venue is in acceptable condition upon inspection and subject to contract terms.
- 3 professional photos of the venue taken with lights up prior to the beginning of the event, must be submitted to Temple Emanuel prior to release of the damage deposit refund.



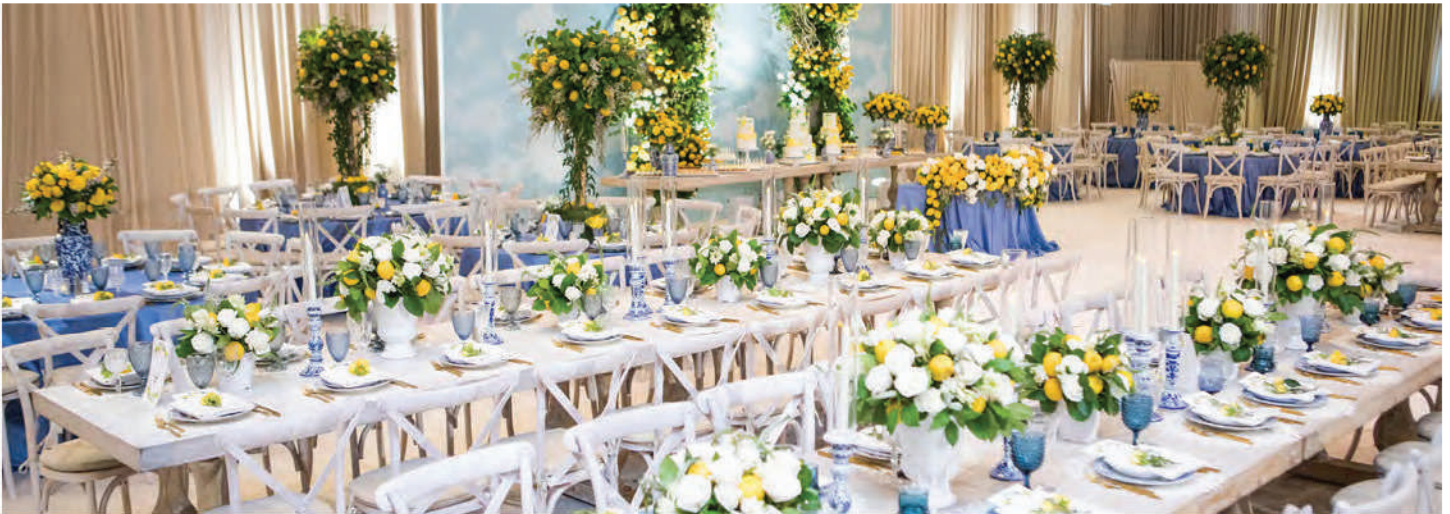

What type of events can be booked at Temple Emanuel?

- Baby namings
 - Birthday parties
 - B'nai Mitzvah parties*
 - Brit Milah
 - Engagement parties
 - Holiday parties
 - Memorials
 - Weddings
- B'nai Mitzvah ceremonies are reserved for Temple members only *

What is required to secure the date and venue for my event?

- 50% payment of the rental fee (non-refundable)
- A signed contract

Can I hold the space without payment?

You can hold one date, one time for up to five business days.

Does my event have to be religious in nature?

No. We welcome religious, secular, social and civic events.

How many people can Temple Emanuel accommodate?

The combined facilities can accommodate from 100 to 550 people. The event spaces vary in size, and the capacity of each will be determined by the desired set-up. We are happy to help you determine which space(s) will work best for you.

Can I rent the space if I'm not a member of Temple Emanuel?

Absolutely! Non-Temple members can rent spaces for any occasion other than a Bar or Bat Mitzvah ceremony.



WEDDINGS, B'NAI MITZVAHS, BIRTHDAYS, ANNIVERSARIES & ENGAGEMENT PARTIES	6 HOURS SAT-SUN	6 HOURS WEEKDAYS	EXTRA HOURS
100-150 GUESTS (UP TO 70 CARS)	\$2215	\$2440	\$218
151-200 GUESTS (UP TO 90 CARS)	\$2380	\$2615	\$246
201-250- GUESTS (UP TO 110 CARS)	\$2725	\$2990	\$274
251-300- GUESTS (UP TO 130 CARS)	\$3060	\$3365	\$330
301-350- GUESTS (UP TO 150 CARS)	\$3400	\$3740	\$386
351-400- GUESTS (UP TO 175 CARS)	\$4250	\$4670	\$520
401-450- GUESTS (UP TO 200 CARS)	\$4961	\$5450	\$676
451-500- GUESTS (UP TO 225 CARS)	\$5765	\$6340	\$910
501-550- GUESTS (UP TO 250 CARS)	\$6705	\$7370	\$1100
MEMORIALS 5 hours of parking included in venue rental fee Licensee pays 10% gratuity based on posted rates	5 HOURS SAT-SUN	5 HOURS WEEKDAYS	EXTRA HOURS
100-200 GUESTS (UP TO 130-150 CARS)	\$3315	\$3642	\$469
201-299 GUESTS (UP TO 151-220 CARS)	\$4395	\$4830	\$652

- * For holidays there will be a surcharge in addition to all prices shown
- * Signed contract required 60 days prior to the event
- * Payment in full required 30 days prior to the event
- * Mandatory 10% gratuity will be added to all contracts
- * Contact the parking office for pricing for other types of events



NAME (AND NOTES)	CONTACT	PHONE	WEBSITE
APPROVED CATERERS			
CATERERS MUST BE SELECTED FROM THIS LIST			
Blueberry Hill *	Kelly	949.435.3400 x 239	blueberryhillcatering.net
Alligator Pear	Abi	818.347.7860	alligatorpearcatering.com
Cornucopia (100% nut free, vegan options)	Elliott	818.909.0075	cornucopiacaterersla.com
Redfish (Sushi & appetizer stations, buffets, carving stations)	Cele & Alex	310.385.5813	redfishkitchen.com
Veronica's Kitchen (Nigerian)	Veronica	310.673.4890	vshoyinka@yahoo.com
Silver Spoons	Scott	818.996.2911	silverspns.com
Sharon* (Persian)	Saed	818.344.7472	sharoncatering.com
Sinai* (Persian)	Raquel & Danny	310.820.0048	kosherpro.com/id/sinai-glatt-kosher-catering
Flavors From Afar (Ethiopian)	Meymuma	323.879.9778	flavorsfromafar.com
Jay Bharat Catering ((Indian)	Jay	562.205.1234	jaybharat.com

(*Glatt Kosher option offered)

IN-HOUSE A/V

Get Launched	Dan	323.810.1465	dan@get-launched.com
LiveStream LA	Avi	310.877.8743	live-streamla.com



Venues at 300 North Clark Drive

- Belle Chapel
- Corwin Family Sanctuary
- Greer Social Hall
- Courtyard
- Foyer

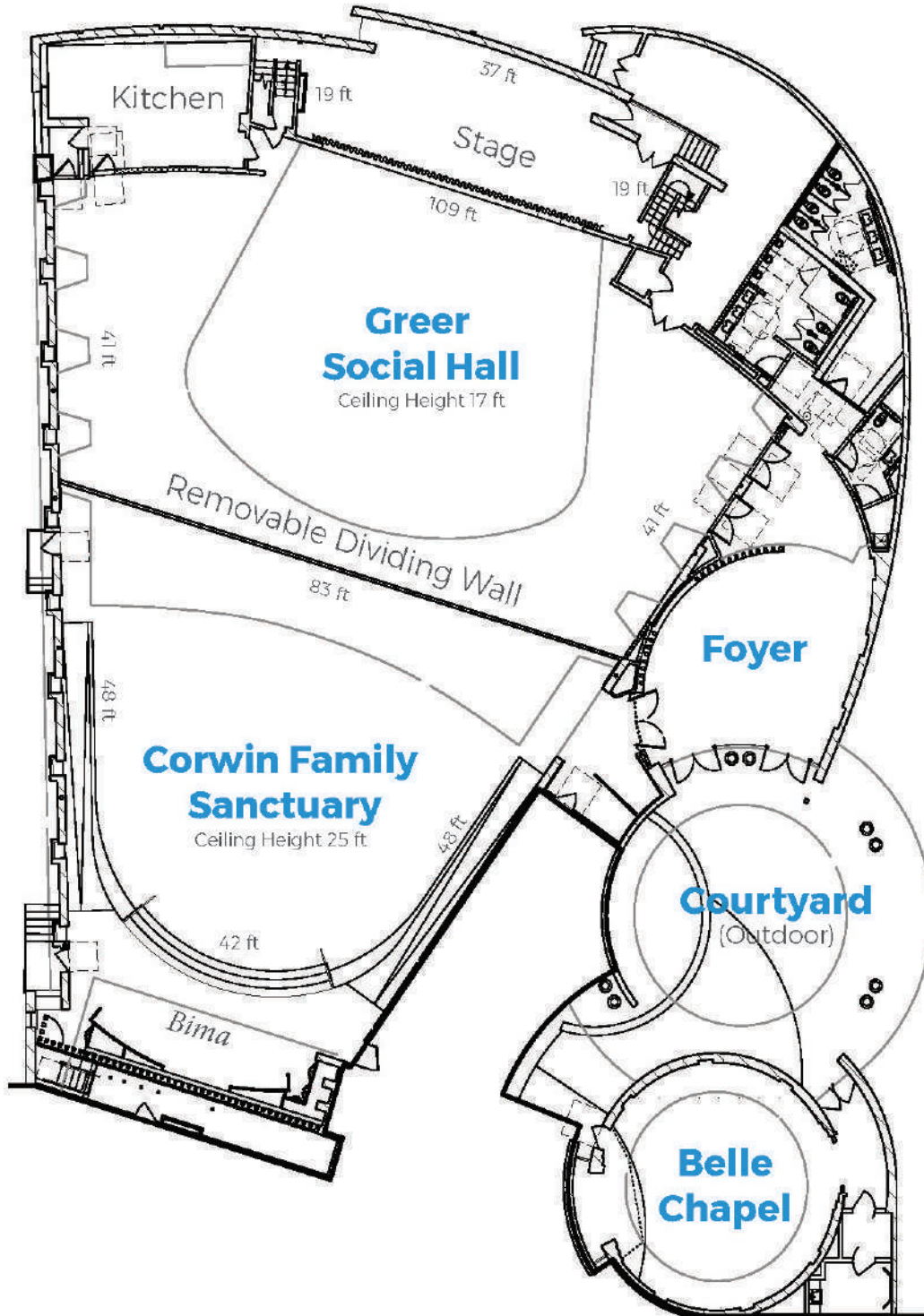



GREER HALL	WHITE	WITHOUT CEILING	WITHOUT LOWER WALL
Complete stage draping	\$800	\$600	\$500



Both walls adjacent to the stage (set of 2)	\$700		
Draping of entire Greer Social Hall	\$3000		

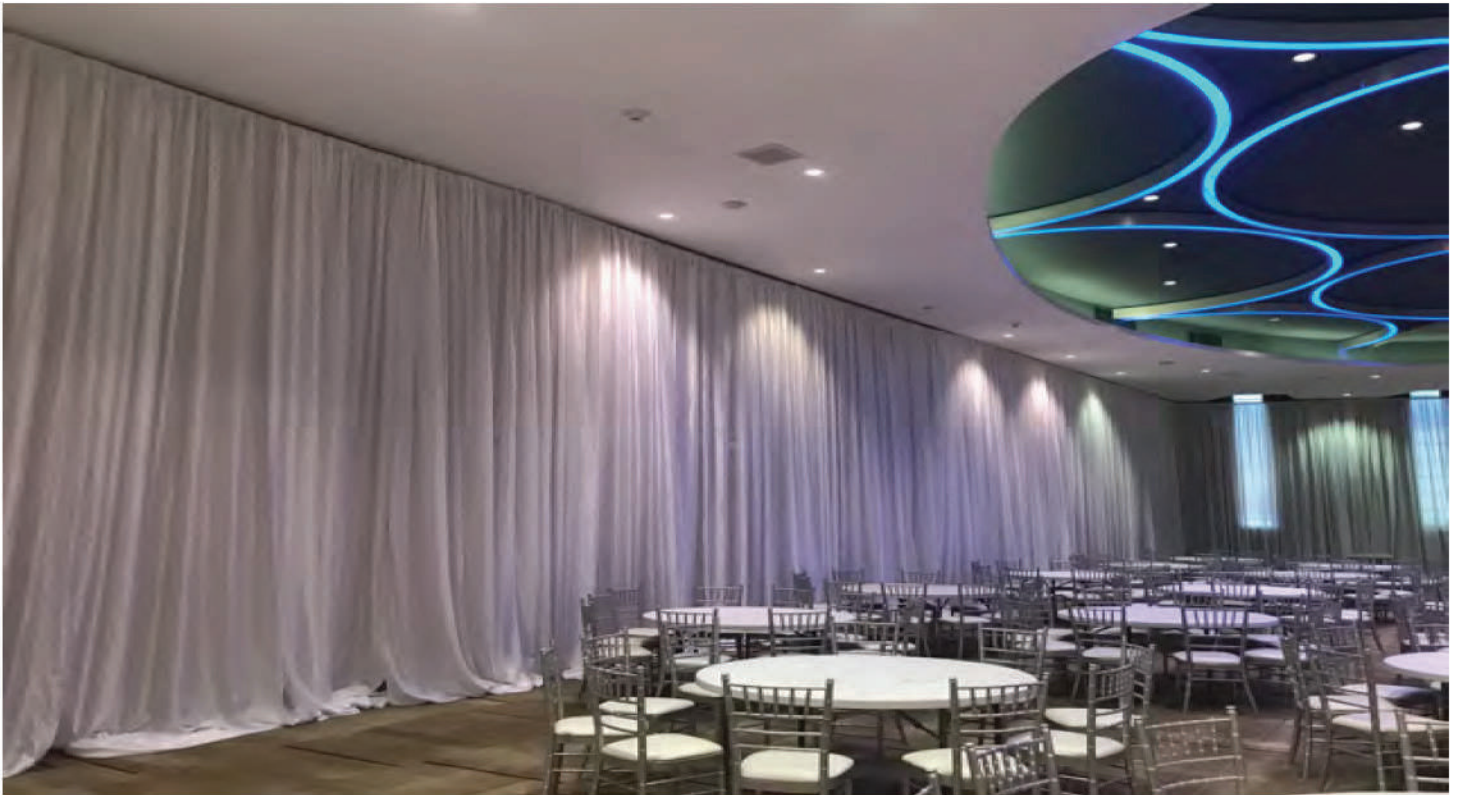

GREER HALL	WHITE		
Partition wall	\$700		



Brick walls (set of 2)	\$800		
------------------------	-------	--	--



THE SANCTUARY	WHITE		
Bima - stage at top of curved ramps	\$600		



Brick walls - price for each (there are 2)	\$600		
--	-------	--	--

* Place draping orders directly with Heavenly Draping * Note Antonio does not participate in walk-thrus * Cash prices include tax & delivery
 * Zelle payments to 323-440-7271 * Bank of America * Elfego Antonio Morales * Due 30 days in advance
 * heavenly_rentals@hotmail.com * Fabric flammability certificates on file with BH Fire Department



THE SANCTUARY	WHITE		
Partition wall	\$700		



THE FOYER	WHITE		
Curved brick wall	\$700		



THE COURTYARD	WHITE		
Entrance covering the columns	\$600		



Curved brick wall covering the sculpture	\$100		
--	-------	--	--



Special Events Furnishings Inventory

GREER HALL

Tables

60" rounds - 55 (seats up to 10 guests)

8' rectangles (30" wide) - 20 (for buffets, or seating)

6' rectangles (30" wide) - 20 (for wedding cake, place card table, gift table, etc.)

Sweetheart tables (serpentine) 170" long X 30" wide X 60" high - 3
(each table requires 2 tablecloths)

Chairs

Silver Chiavari chairs - 299

(when a contract is for more than 299 guests, TEBH rents additional chairs)

Dance Floor: 28' X 24' white (may be made smaller)

Easels - 4

Podium - 1 (beautiful acrylic, perfect for speeches, awards banquets, book readings)

Overhead projector screen 80" wide by 56" high (mobile) - 1 (fits on stage)

Overhead projector - 1

Circular riser: 10' diameter X 12" high (for cake cutting ceremony, sweetheart table)

Stairs to access stage (may be decorated with flowers)

Stainless steel trash cans - 6

SANCTUARY

Chairs

299 beige arm chairs

Overhead Projector - 1

Screen - 1, lowers down from above Bima

Cordless Microphones - 3

Piano - 1

FOYER & COURTYARD

High-boy 104" X 36" tall cocktail tables - 7

Low-boy 70" X 36" cocktail tables - 7

Shoji screens - 8

Cooking and Heating

INDOORS: STERNO ONLY

Propane fuel is not allowed. These cooking stations are examples of the types allowed with sterno heating only:

Bananas Foster/Crepes Suzette pans
Chafing dishes
Griddles
Gyro rotisserie spits
Omelette pans
Soup kettles
Woks

PROHIBITED ANYWHERE ON TEMPLE PROPERTY

Barbecuing
Deep fryers (portable)
Doughnut machines
Naan bread clay cookers
Open flames of any kind
Pizza ovens

PROHIBITED BEVERAGES

Exhibition bartending with sparklers or “cold flares”
Flaming cocktails

NO COOKING IN THE ALLEY

NO COOKING ON PUBLIC SIDEWALKS OR RIGHT-OF-WAY



Temple Emanuel Venue Rentals

There are four payment options:

#1 - Check via post office

Mail to:

Temple Emanuel

300 North Clark Drive

Beverly Hills, CA 90211

Attention: Accounting

#2 - Online check via your personal checking account

#3 - Credit Card via the temple's website:

<https://tebh.org/venues-2/pay-online/>

#4 - ACH Wire:

Account Name: TEMPLE EMANUEL OF BEVERLY HILLS

Account Number Checking - 80008086458

Domestic Wire / ACH Instructions Wire / Credit Funds to:

First Republic Bank

101 Pine Street

San Francisco, CA 94111

ABA / Routing Number: 321 081 669

SWIFT Code: FRBBUS6S

\$1500 DAMAGE DEPOSITS MAY ONLY BE PAID BY CHECK OR WIRE

Any late payments made within 30 days of the event must be paid by check or wire. Any last minute bookings such as a memorial or Bris must be paid for by check or wire in entirety (venue rental fee + damage deposit).



WORKSHEET CALCULATE YOUR PRICE TOTAL OCCUPANCY COST

REQUIRED CHARGES	WALL DOWN	WALL UP
VENUE RENTAL FEE	\$ _____	\$ _____
DAMAGE DEPOSIT	\$ _____	\$ _____
VALET PARKING	\$ _____	\$ _____
PERMITS	\$ _____	\$ _____
TOTAL	\$ _____	
DRAPING OF BIMA		\$ _____
FIRE MARSHALL		\$ _____
TOTAL		\$ _____