



Basic Rental Information 2024-2025

Museum Space Options

LEIR HALL

Located on lower level of Museum

Capacity 200 guests seated at tables and chairs; with dance floor
250 guests at a standing cocktail party (no tables with chairs; high-tops only)
200 seated banquet style; with small dance floor

Fees Friday-Sunday evening rental (6-11 p.m.): **\$5,000**
Monday-Thursday evening rental (6-11 p.m.): **\$4,000**
Friday-Sunday afternoon rental (12 noon-5 p.m.): **\$4,000**
Monday-Thursday rental (10 a.m.-4 p.m.): **\$3,000**

- *Includes an elevated stage*
- *All food and beverages are allowed in this area*

LEHMAN COURT

Located on main level of Museum, at Front Entrance, adjacent to galleries

Capacity 60-65 guests seated at tables and chairs
80 guests at a standing cocktail party (no tables & chairs; limited number of high-tops only)

Fees Friday-Sunday evening rental (7-11 p.m.): **\$4,000**
Monday-Thursday evening rental (6-11 p.m.): **\$3,500**
Monday-Thursday day rental (10 a.m.-6 p.m.): **\$3,000**

- *At time of booking, we may be unaware of any upcoming closures in the galleries due to exhibition change*
- *Because the Museum is open to the public until 6 p.m. on Friday and Saturday, Lehman Court cannot be rented before 7 p.m. on those days (6 p.m. on Sundays)*
- *Only clear beverages allowed in Lehman Court: no red wine, colas, coffee, tea, or colored liquids*
- *No food or drink permitted in Galleries*

LEIR HALL with LEHMAN COURT *

Fees Friday-Sunday evening rental (7-11 p.m.): **\$7,000**
Monday-Thursday evening rental (6-11 p.m.): **\$5,500**
Monday-Thursday day rental (10 a.m.-6 p.m.): **\$4,500**

- * *Please note: Use of Lehman Court and access to galleries lasts until 8 p.m. only when rented with Leir Hall*

Museum Space Options

SOUTH MOUNTAIN AVENUE FRONT LAWN

This space may be rented for **\$200** to hold a wedding ceremony in conjunction with the rental of Leir Hall and/or Lehman Court. You are strongly advised to rent a canopy or tent for your comfort and that of your guests. MAM chairs cannot be used outside; rental chairs are required. Additional information can be provided at the time of your site visit.

Friday–Sunday evening rental* (6–11 p.m.): **\$3,500**

Monday–Thursday evening rental* (6–11 p.m.): **\$2000**

Monday–Friday (10 a.m.–4 p.m.): **\$200/hour** or **\$1,000** full day (September–June only)

Saturday–Sunday (10 a.m.–4 p.m.): **\$300/hour**

**Montclair music ordinance calls for 10 p.m. end*

You may add galleries, restrooms, and caterer’s pantry to your lawn rental at the following price:

	Restrooms	Galleries*	Pantry
Monday–Friday, 9 a.m.–4 p.m.	\$100	\$1,000	\$300
Monday–Thursday, 6–10 p.m.	\$100	\$1,500	\$400
Saturday–Sunday, 10 a.m.–4 p.m.	\$100	\$1,000	\$300
Friday–Sunday, 6–10 p.m.	\$200	\$1,500	\$500

**Galleries will remain open to your guests until 8 p.m.*

GEYER STUDIO

This studio may be rented in conjunction with the rental of Leir Hall alone or with the rental of Leir Hall with Lehman Court for **\$300**, subject to availability and the approval of the Director of Yard School of Art.

ART STUDIOS A, B, C

These studios may be rented in conjunction with the rental of Leir Hall alone or with the rental of Leir Hall with Lehman Court for **\$300**, subject to availability and the approval of the Director of Yard School of Art.

Museum Additional Add-On Options

MAM ART TRUCK

The Montclair Art Museum Art Truck is the perfect fun activity for your mitzvah or a special hands-on art treat for the children at your adult event. The colorful, cheerfully painted truck is a mobile open studio, housed in a retrofitted ice cream truck that offers art projects your guests will enjoy on site for **\$400** for two hours.

PORTABLE BAR

The bar may be rented in conjunction with the rental of Leir Hall and/or Lehman Court for **\$100** for the evening (placed in one location for the entire evening).

UPLIGHTING

NEW! 12 piece up-lighting in a variety of colors, **\$500**.

AV PACKAGE

Use of AV package with a staff AV oversight, **\$500**.
Includes lighting, sound, and video for your event.

Included in Your Rental

TABLES

(21) **60" round tables** (seats 8 using MAM chairs; 10 using rental chairs)

(11) **72" round tables** (seats 10 using MAM chairs; 12 using rental chairs)

(8) **6' rectangular tables** (seats 6)

(8) **5' rectangular tables** (seats 4) cannot be used in Lehman Court, use in Leir Hall only

(12) **30" round low-top tables**

(12) **30" round high-top tables** please note that these high-tops can be lowered to provide a potential total of 24 low-tops

CHAIRS

250 chairs

MICROPHONES AND STANDS

1 wired

2 cordless

2 lavaliers

1 microphone stand

5 music stands

2 podiums

SOUND SYSTEM AND SCREEN

Allen & Heath QU-16 mixer (uses laptop or tablet; needs HDMI)

Blu-ray player, iPad

Dell PC laptop

Full Size Theater Screen (25' x 20') and new state of the art projector

Stage has 3 back lines for band setup

Large 70" portable monitor by Sharp

PARKING

Museum parking lot for 140 cars; you may hire a valet parking service if you wish.

PLEASE NOTE

Renters are required to provide a **Certificate of Liability** naming the Montclair Art Museum as an additional insured (details are spelled out in the contract).

Renters must also provide a **credit card authorized for up to \$1,000 as a security deposit** for any damage noted after the event (see contract for details).

Only caterers on our **Approved Caterers** list may be employed for your event (attached). Please email Carol Taylor, Retail and Rental Operations Manager, for an appointment and additional details: ctaylor@montclairartmuseum.org.

MAM Approved Caterers

CHURCH STREET CATERING

Phone: 973-220-0031
churchstreetcatering.com

We are a full service catering company offering custom designed menus and a full range of services from rentals to photographers to florists and more. Allow our professional staff to help you create your perfect memory.

DAVID ELLIS CATERING

Phone: 973-539-3000
davidelliscatering.com

Simple events to extravagant galas—we take pride in providing an outstanding level of service. Our all-inclusive event production includes menu design, staffing, floral design, entertainment, and tenting.

ENCORE CATERING

Phone: 973-515-8000
encorecateringnj.com

Our dedicated staff provides expert consultation and recommendations based on event criteria, preference, budget, and theme. Our menu options are endless—completely customized to please the palate of every guest on your list.

EVENTS BY JONI

Phone: 973-783-5222
eventsbyjoni.com

Full service event planning with a commitment to the highest level of catering and design. Joni has earned the reputation of respect and success based on customer referrals, excellent work ethic and the creative and positive energy she brings to every event.

GREEN CART CATERING

Phone: 201-885-4425
greencartcatering.com

We offer full service vegan and vegetarian catering. We are committed to providing healthy and ethical cuisine to hosts that want to stay true to their values while still providing an outstanding culinary experience.

HARVEST RESTAURANTS

Phone: 973-656-1881
harvestrestaurants.com

Harvest Restaurants are designed for you to enjoy local, seasonal food and award-winning wine and spirit offerings. Whether you're in the mood for casual light fare or an elegant dining experience, Harvest Restaurants can satisfy your appetite.

IN-THYME CATERED EVENTS

Phone: 201-774-8646 and 201-666-3353
inthyme.com

From weddings to intimate cocktail parties to large corporate affairs and trade shows—our goal is to not only provide the highest quality food and service, but to also become a trusted partner in planning your event.

JACK'S SEAFOOD SHACK

Phone: 973-893-5283
jacklobstershack.com

Seafood, including Maine lobsters, crabs, shell fish and more for all of your entertaining events.

LAURENCE CRAIG CATERING

Phone: 973-761-0190
laurencecraigcatering.com

Boutique off premise catering company specializing in customized cuisine, poised service and unique presentation. Our focus is on high-end weddings, mitzvahs, fundraising galas and corporate events.

MANGIA BUONO CATERERS

Phone: 347-865-2237
mangiabuonolaliers.com

Brooklyn homestyle Italian Cooking. No party too big or too small. Outstanding services and catering.

MOGHUL CATERING

Phone: 732-841-7127
moghulcatering.com

We specialize in Indian cuisine with subtle simplicity, and fine ingredients reflecting our cultural heritage. We believe in perfection, paying attention to the smallest detail to make your event magnificent.

RASOI FINE INDIAN CUISINE AND CATERING

Phone: 732-429-8150
cateringbyRasoi@gmail.com

Behind every meal is a conversation waiting to happen. We stride towards providing first-class Indian food at an affordable price, and make sure your dining experience is special.

RICHFIELD REGENCY

Phone: 973-239-6234
richfieldregency.com

We are a full service kosher caterer under rabbinical supervision. Our professional staff provides top-quality services and outstanding catering. Full service non-kosher menu also offered.

Special Services Vendors

FLORISTS

Bartlett's

Phone: 973-471-6480

Blade Floral and Event Designs

Phone: 917-723-3577
bladenyc.com

Events by Broderick

Phone: 800-966-1773
brodericks.net

Jerry Rose Design

Phone: 973-471-6480
jerryrose.com

ORCHESTRA/MUSIC/DJS

DJ Matthew Krause

matthewkrausecb@gmail.com

DJ Show N Tell

Phone: 347-228-6159
djshowntell.com

Dolce DaVita Strings

Phone: 848-391-3583
www.ddstrings.com

Hank Lane Music & Productions

Phone: 212-767-0600
hanklane.com

John Hubela, DJ

Phone: 800-CDJ-0404
www.cdjmusic.com

Mark Yolleck, Trio

Phone: 973-783-1125

New Jersey Rhythm & Blues

Phone: 201-556-4559
info@njrb.net

Princeton Music Connection/Wendy Zoffer

Phone: 609-936-9811
princetonmusic.com

Vail Entertainment

Phone: 201-768-9100
vail.com

SERVERS AND STAFFING

Raise Your Pinky

Phone: 201-484-9885
Raiseyourpinkystaffing@gmail.com
Not in need of full catering? We supply light menus and all needed staffing and bartenders.

VALET PARKING

Country Club Services

Phone: 973-376-4352
countryclubservicesinc.com

BUS COMPANY (shuttles, vans, etc.)

Academy Bus

Phone: 800-442-7272
academybus.com

PHOTOGRAPHERS

Ade Oshadi

Phone: 860-502-4129
adeandgina.com

Andy Foster Photography

Phone: 973-632-8000
andyfosterphoto.com

Celestina Ando Photography

Phone: 201-381-0180
celestinaando.com

Dave Hollader

Phone: 973-467-0870
davidhollander.net

Daniel Epstein & Associates

Phone: 973-783-5149
danepstein.zenfolio.com

Lindsey Reed Photography LLC

Phone: 908-399-9525
lindseyreedphotography.com

Mike Peters Photography

Phone: 973-857-8969

Phil Cantor Photography

Phone: 973-783-1065
philcantor.com

Richard Titus

Phone: 973-670-1292
richard@titusphoto.com

Special Services Vendors

VIDEOGRAPHERS

Absolute Video

Phone: 973-740-0900

Sweet Molly Films

Phone: 973-783-3400
sweetmollyfilms.com

LIGHTING AND FURNITURE

Bubble Design Rentals

bubbledesignrentals.com

Front Page Productions

Phone: 973-696-6886
frontpageproductions.com

JB Lighting Productions

Phone: 917-834-1902
jblightingproduction.com

Jersey Street Furniture (rental)

Phone: 973-779-7444
jsfrental.com

Shine Events

Phone: 845-535-3100
shineevents.com

Showpro Productions

Phone: 908-578-1672
showproproductions.com

Sperry Tents

Phone: 732-681-8368
SperryTentsNJ.com
Tents may not be staked. Only weighted tents are permissible.

WEDDING / EVENT PLANNERS

Blush Events

Phone: 914-629-4843
info@blushevents.net

Bowmans Party Creations, LLC

Phone: 862-220-7472

Castiglione Events

Phone: 732-600-9666
castiglioneevents.com

Elegant Occasions

Phone: 888-361-9177
elegantoccasions.com

PrincEvents

Phone: 610-212-7108
lisaprincevents.com

Raise Your Pinky

Phone: 201-484-9885
Raiseyourpinkystaffing@gmail.com

HOTELS IN THE AREA

The MC Hotel

Book your wedding room block and receive:

- One upgrade at the group rate
- Marriott Bonvoy Points
- Exclusive discount for your Welcome Reception/ Rehearsal Dinner

690 Bloomfield Avenue, Montclair, NJ
Phone: 844-624-6835
themchotel.com

Best Western Turtle Brook Inn

555 Northfield Avenue, West Orange, NJ
Phone: 973-731-5300
bestwesternnewjersey.com

Courtyard by Marriott

8 Rooney Circle, West Orange, NJ
Phone: 973-669-4725
marriott.com

The George

37 N. Mountain Avenue, Montclair, NJ
Phone: 973-783-7878
thegeorgemontclair.com

Newark Hilton

1048 Raymond Blvd, Newark, NJ
Phone: 973-622-5000
hilton.com

Residence Inn West Orange

107 Prospect Avenue, West Orange, NJ
Phone: 973-669-4700
marriott.com

Short Hills Hilton

41 John F Kennedy Pkwy, Short Hills, NJ
Phone: 973-379-0100
hilton.com

Directions to the Museum

New Jersey Turnpike North or South (stay on Western Spur) to Exit 15W to 280 West to Exit 8B, Prospect Avenue/Cedar Grove. Proceed through 4 lights. At the fifth light turn right onto Bloomfield Avenue. At third light turn right onto South Mountain Avenue. Turn into the second driveway on the left. Alternate Turnpike Exits: Turnpike North - Exit 16W Follow as below for Route 3 West. Turnpike South - Exit 11 to Follow as below for Garden State Parkway North.

Garden State Parkway North to Exit 148, Bloomfield Avenue. After toll stay left. Proceed through light and follow jug handle. Turn right onto Bloomfield Avenue and proceed for 2.7 miles. At Montclair Jaguar stay left and turn left at the second light onto South Mountain Avenue. Turn into the second driveway on the left.

Garden State Parkway South to Exit 148, Bloomfield Avenue. Proceed straight through the ramp. Turn right onto Bloomfield Avenue. Follow directions from Bloomfield Avenue above.

Route 280 East or West to Exit 8B, Prospect Avenue/Cedar Grove. Proceed through five lights. At the sixth light turn right onto Bloomfield Avenue. At third light turn right onto South Mountain Avenue. Turn into the second driveway on the left.

Route 287 North or South to 80 East to 280 East to Exit 8B, Prospect Avenue/Cedar Grove. Follow as above for Route 280.

Route I-78 East to I-287 North (Morristown). Go approx. 20 miles to exit 41A to Route I-80 (Smith Rd., NYC). Take exit 47A to I-280 east (keep right). Follow 280 to exit 8B (Prospect Ave./Cedar Grove). At sixth traffic light turn right onto Bloomfield Avenue. At second traffic light turn right onto South Mountain Ave., second driveway on left is our parking area.

Route 3 East or West to Grove Street Exit. Follow signs for Montclair. Follow Grove Street through seven lights (approx. 4 miles). Turn right at the eighth light onto Bloomfield Avenue. Proceed approx. 2 miles. At Montclair Motors stay left and turn left at the second light onto South Mountain Avenue. Turn into the second driveway on the left.

FROM NEW YORK CITY:

George Washington Bridge/Route 80 West to Garden State Parkway South, Exit 148 Bloomfield Avenue. Follow as above.

Lincoln Tunnel to Route 3 West - Follow Route 3 to Grove Street exit. Follow as above.

Holland Tunnel - bear left, following signs to Routes 1 & 9. After underpass take second exit. Follow signs to Newark. Bear right for Route 280 West and take 280 West to Exit 8B, Prospect Avenue/Cedar Grove. Follow as above from 280 West.

BY BUS FROM NEWARK:

New Jersey Transit #11 from Penn Station. Take bus to the corner of South Mountain and Bloomfield Avenues, Montclair. For schedule, call New Jersey Transit at 800-772-2222.

Museum Space Dimensions

FIRST FLOOR:

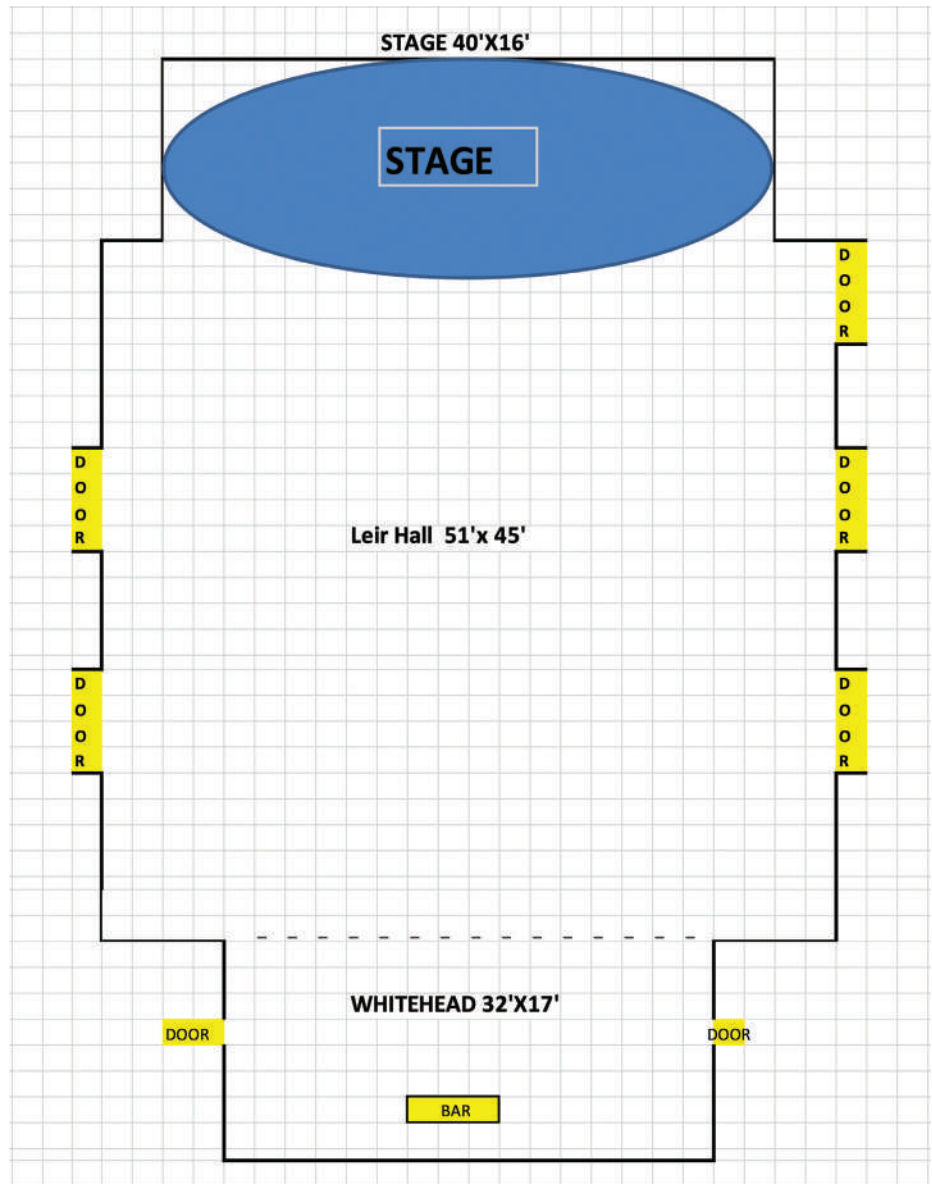

SECOND FLOOR:

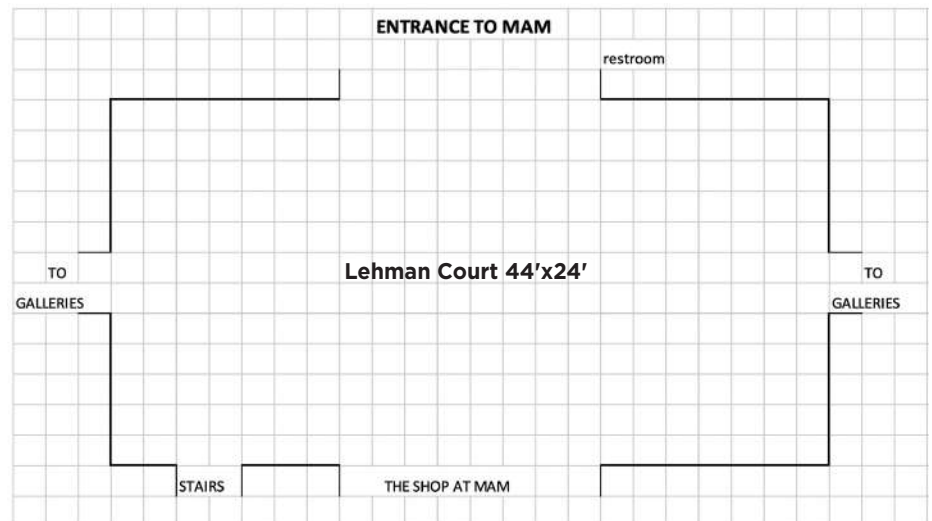

Through art, we create experiences that inspire, challenge, and foster community to shape our shared future. Thank you for considering the Montclair Art Museum.

For further information, please contact

Carol Taylor

Manager of Rental and Retail Operations

ctaylor@montclairartmuseum.org