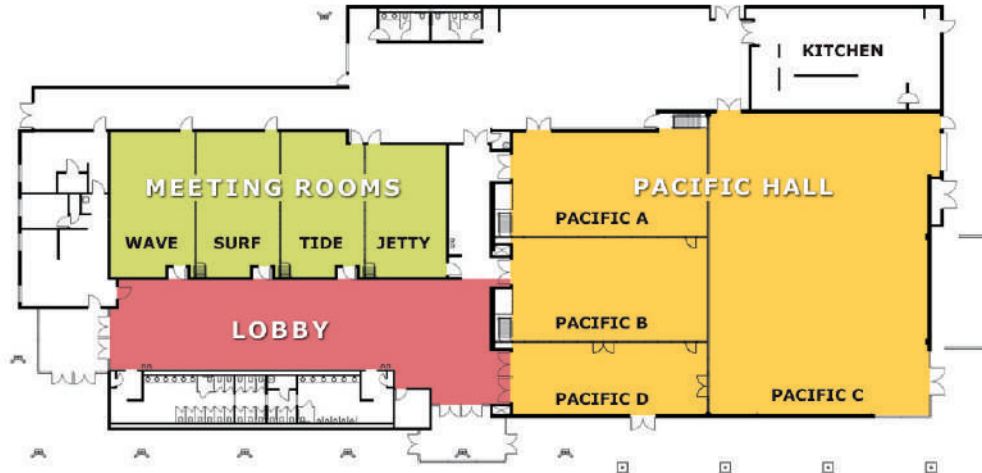

**FACILITY LAYOUT**

**CAPACITY**

room	8 x 10' booth	theater	dining	classroom	reception	room size	sq. feet
<b>Pacific Hall</b> (ceiling height 24')							
<b>PACIFIC A</b>		180	125	100	200	32'x56'	1,792
<b>PACIFIC B</b>		180	125	100	200	32'x56'	1,792
<b>PACIFIC C</b>	28	500	300	300	500	63'x87'	5,481
<b>PACIFIC D</b>		140	100	60	100	20'x56'	1,120
<b>PACIFIC A &amp; B</b>	18	360	250	200	400	64'x56'	3,584
<b>PACIFIC A, B &amp; C</b>		n/a	600	n/a	900	119'x87'	9,065
<b>PACIFIC A, B, C &amp; D</b>	58	1000	720	560	1000	119'x87'	10,185
<b>Meeting Rooms</b> (ceiling height 16')							
<b>WAVE</b>	4	95	50	42	126	24'x42'	1,008
<b>SURF</b>	4	95	50	42	126	24'x42'	1,008
<b>TIDE</b>	4	95	50	42	126	24'x42'	1,008
<b>JETTY</b>	3	80	30	36	110	24'x38'	912
<b>WAVE, SURF</b>	8	180	100	108	250	48'x42'	2,016
<b>WAVE, SURF, TIDE</b>	13	306	160	156	385	72'x42'	3,024
<b>WAVE, SURF, TIDE, JETTY</b>	19	367	200	198	500	96'x42'	3,936
<b>SURF, TIDE</b>	8	190	100	84	252	48'x42'	2,016
<b>SURF, TIDE, JETTY</b>	11	270	130	120	362	72'x42'	2,928
<b>TIDE, JETTY</b>	7	175	80	78	236	48'x42'	1,920
<b>Lobby</b>	13	n/a	n/a	n/a	400	26'x108'	2,808