

All Ballroom and Meeting Rooms

All Ballroom and Meeting Rooms are capable of accomodating higher occupancy.
Please contact hotel to have a diagram made specifically for your event.

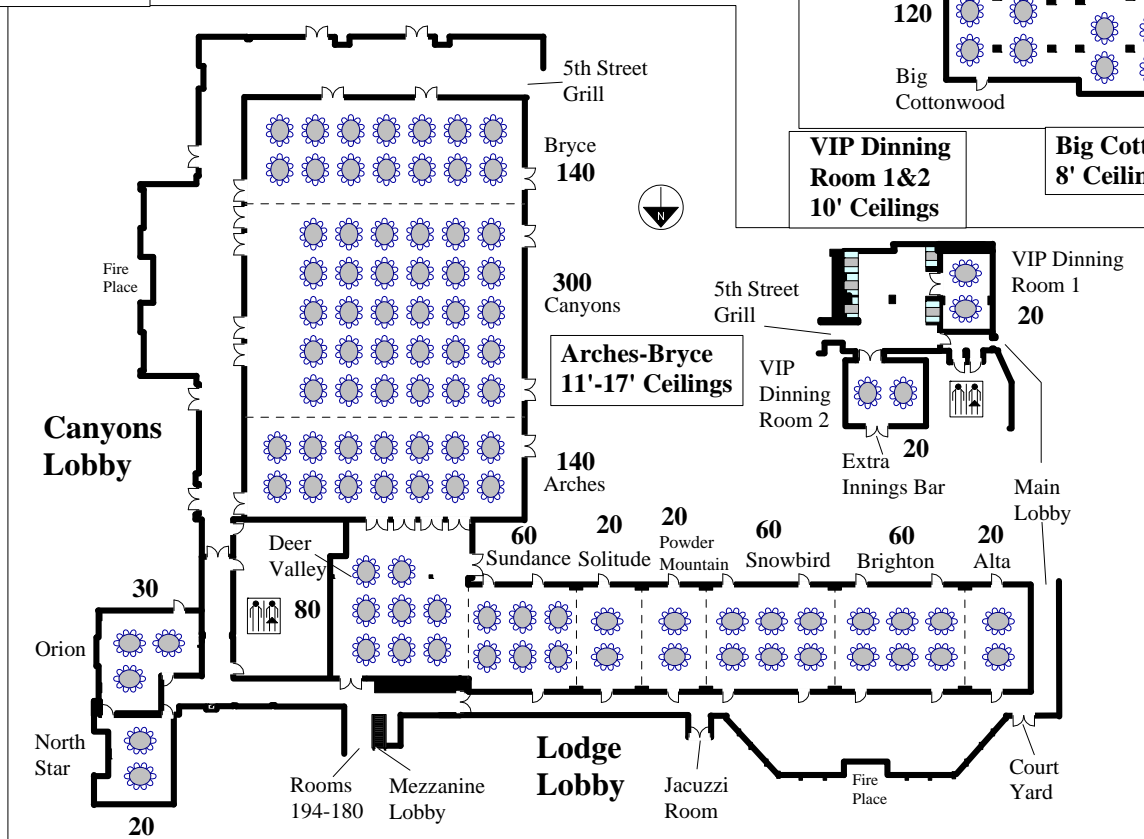

= Restrooms

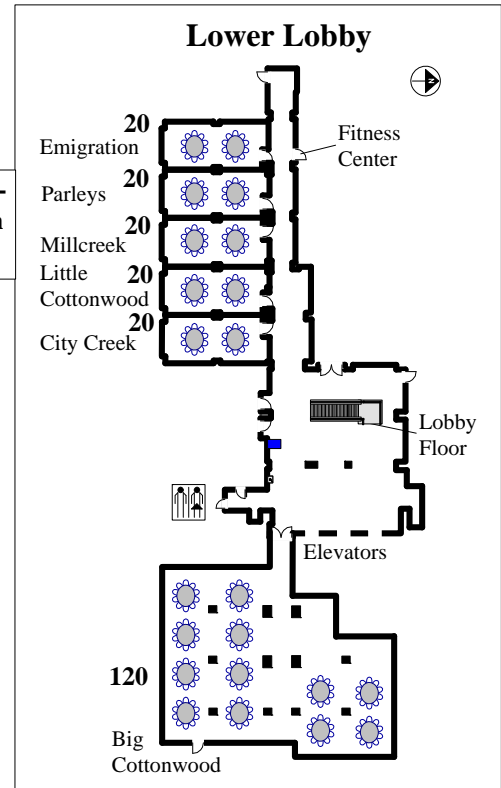
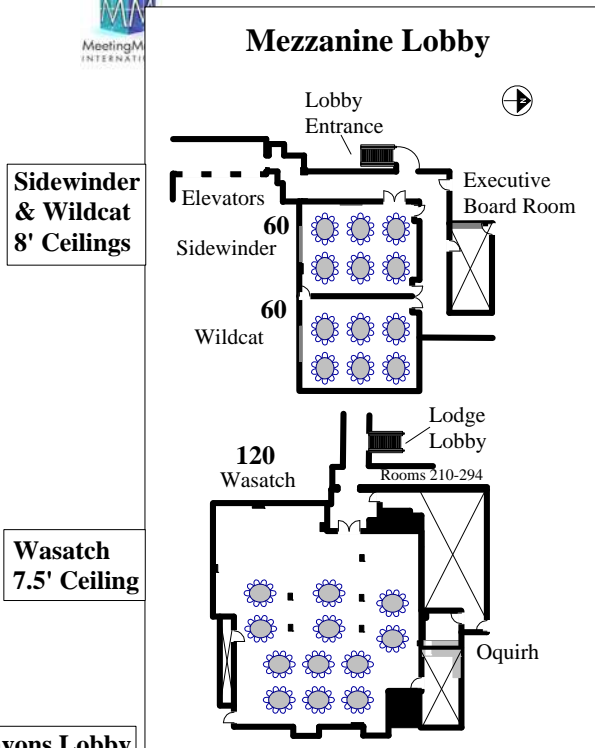

North Star & Orion 8' Ceilings

Alta-Deer Valley 10' Ceilings

Lodge Lobby 10'-12.5' Ceiling

All Ballroom and Meeting Rooms

All Ballroom and Meeting Rooms are capable of accomodating higher occupancy.
Please contact hotel to have a diagram made specifically for your event.



= Restrooms

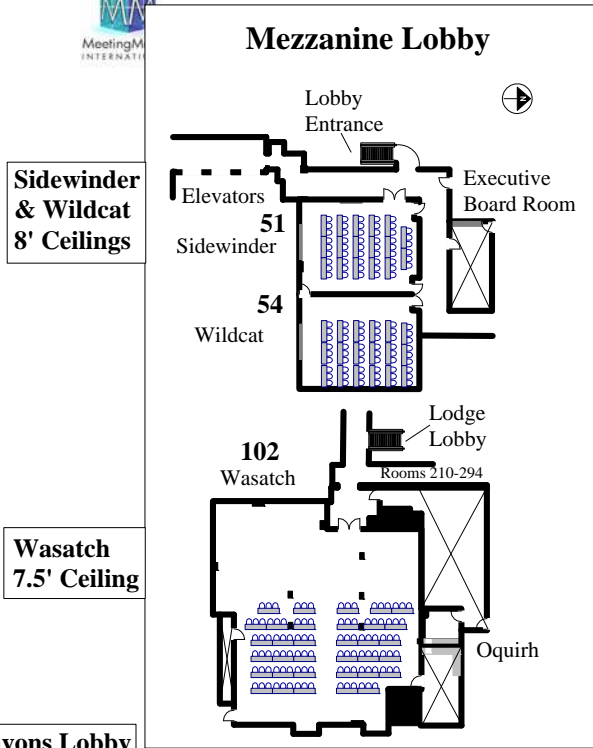

Sidewinder & Wildcat
8' Ceilings

Wasatch
7.5' Ceiling

Canyons Lobby
12'-17' Ceiling

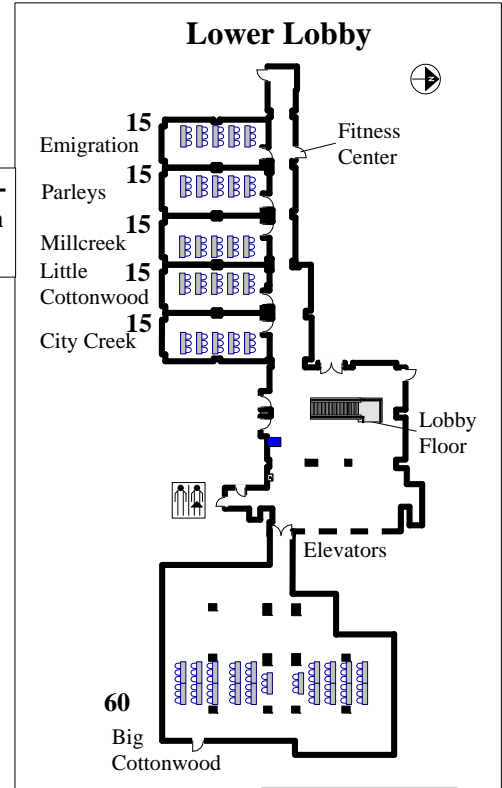

City Creek-Emigration
8' Ceilings

Big Cottonwood
8' Ceiling

VIP Dinning Room 1&2
10' Ceilings

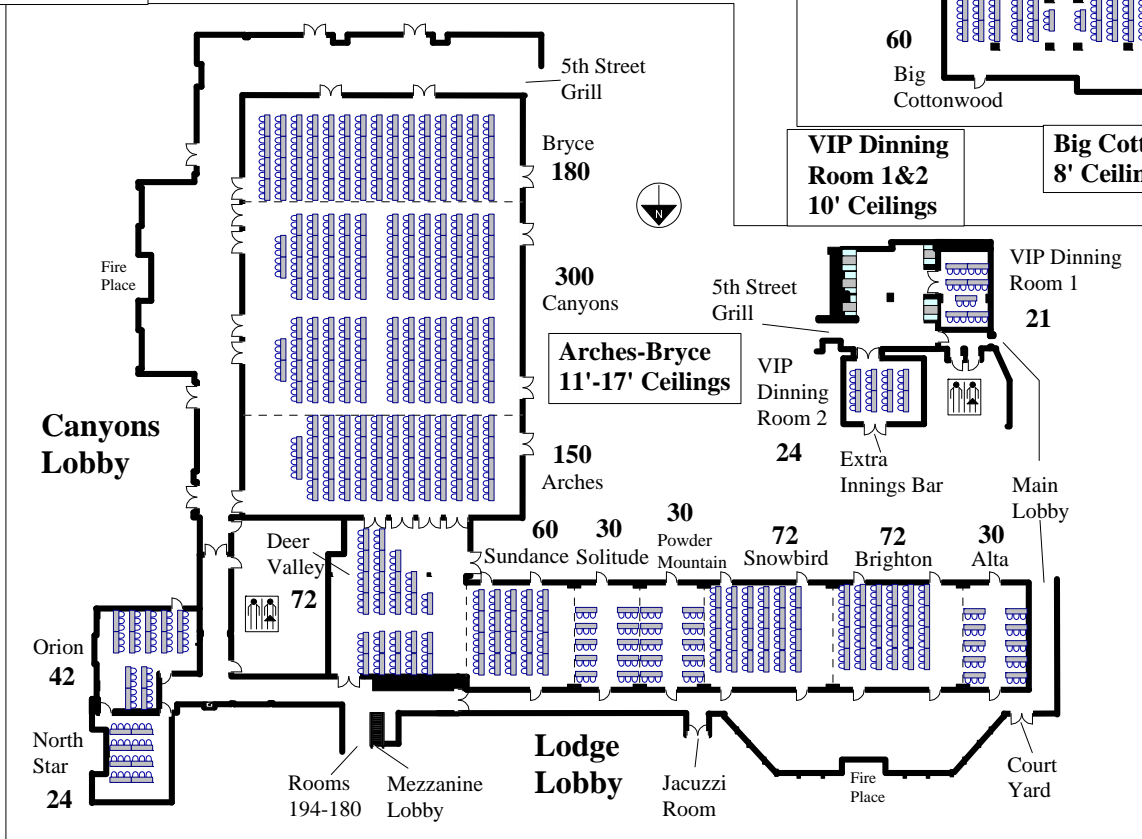

North Star & Orion
8' Ceilings

Alta-Deer Valley
10' Ceilings

Lodge Lobby
10'-12.5' Ceiling

All Ballroom and Meeting Rooms

All Ballroom and Meeting Rooms are capable of accomodating higher occupancy.
Please contact hotel to have a diagram made specifically for your event.



= Restrooms

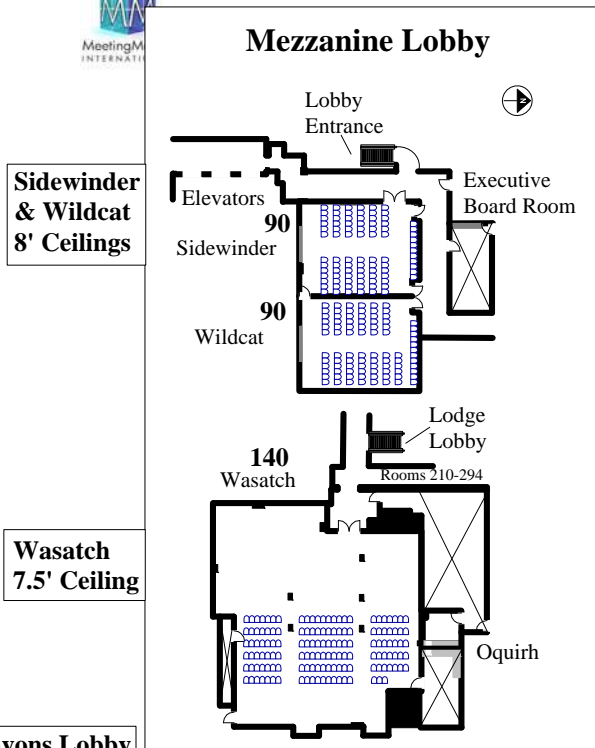

**Wasatch
7.5' Ceiling**

**Canyons Lobby
12'-17' Ceiling**

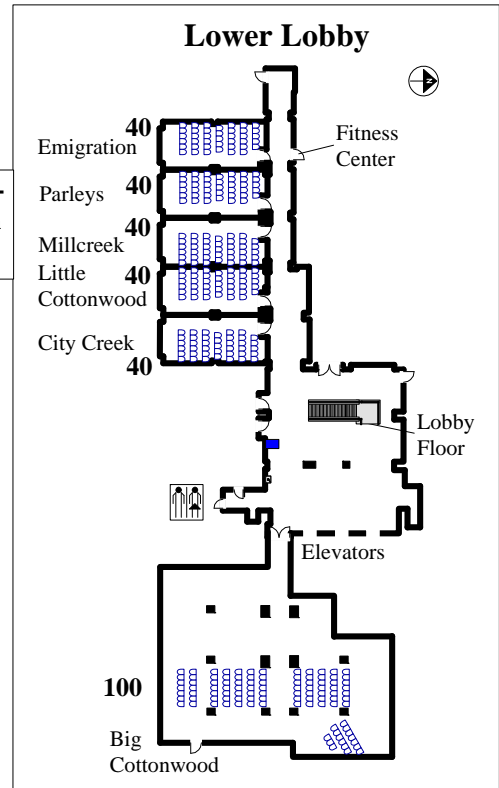

**City Creek-
Emigration
8' Ceilings**

**VIP Dining
Room 1&2
10' Ceilings**

**Big Cottonwood
8' Ceiling**

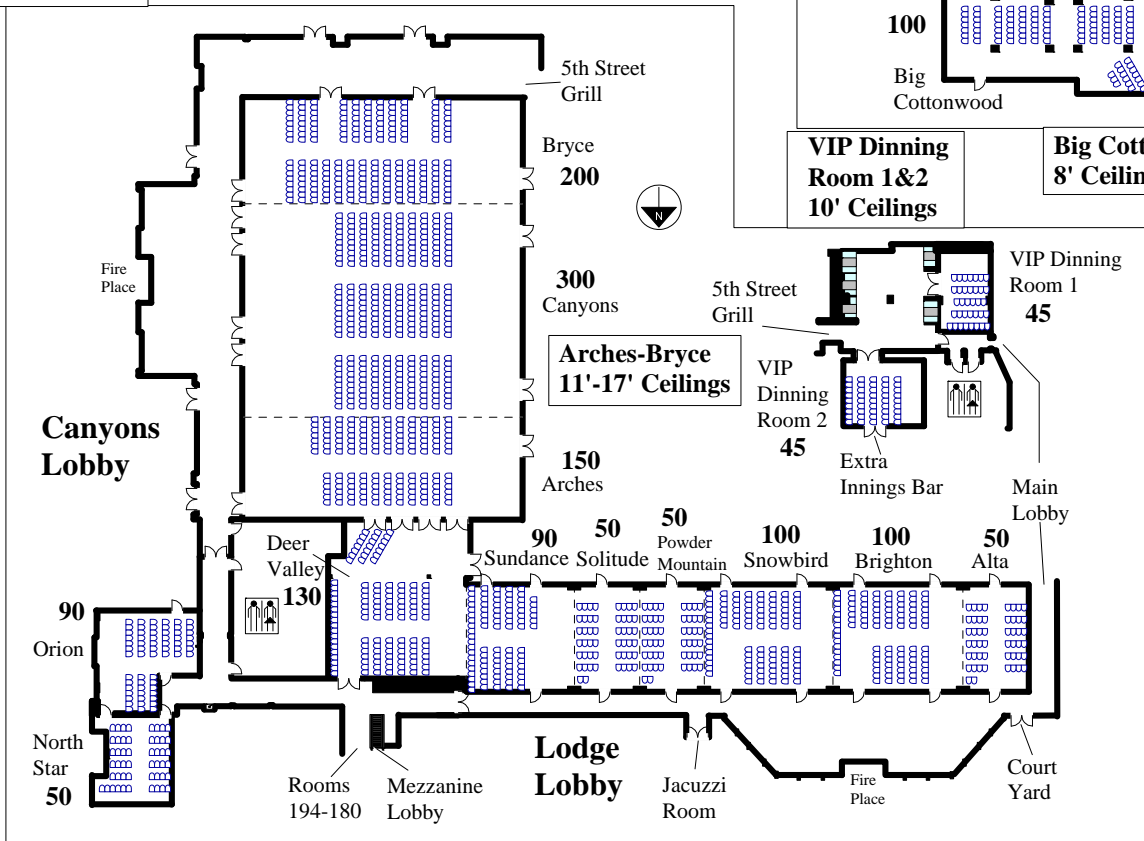

**North Star
& Orion
8' Ceilings**

**Alta-Deer Valley
10' Ceilings**

**Lodge Lobby
10'-12.5' Ceiling**

All Ballroom and Meeting Rooms

All Ballroom and Meeting Rooms are capable of accomodating higher occupancy.
Please contact hotel to have a diagram made specifically for your event.



= Restrooms

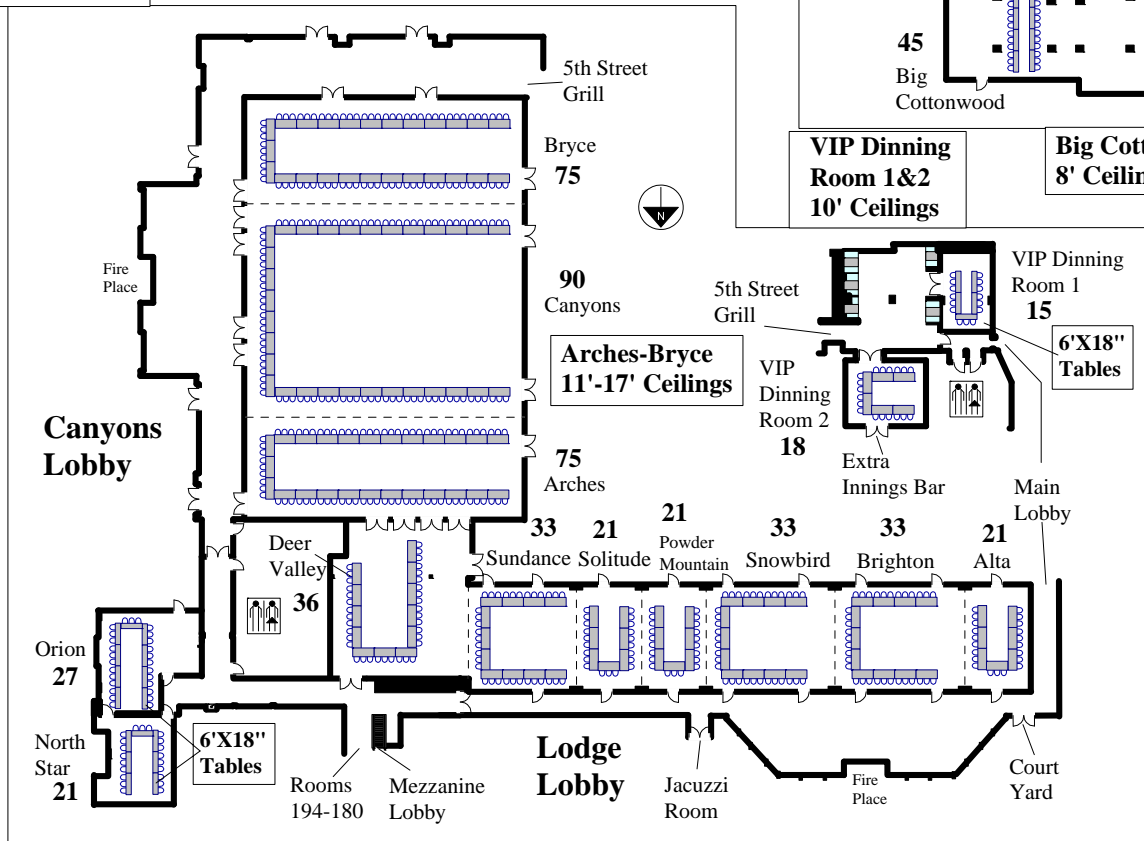
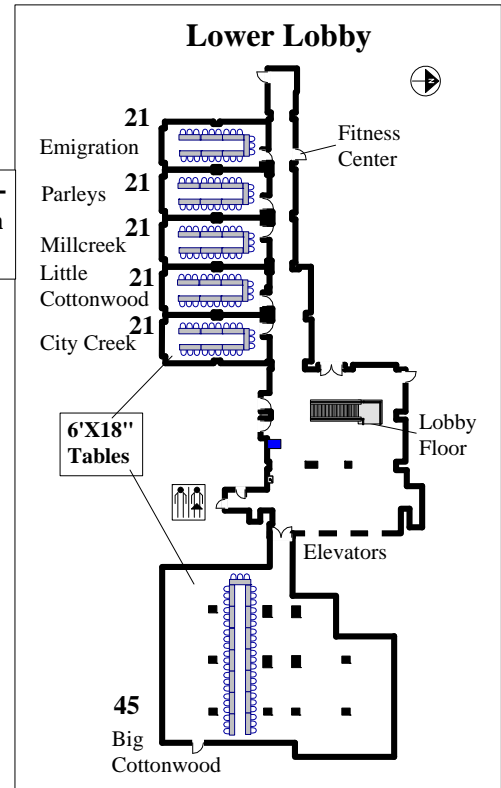
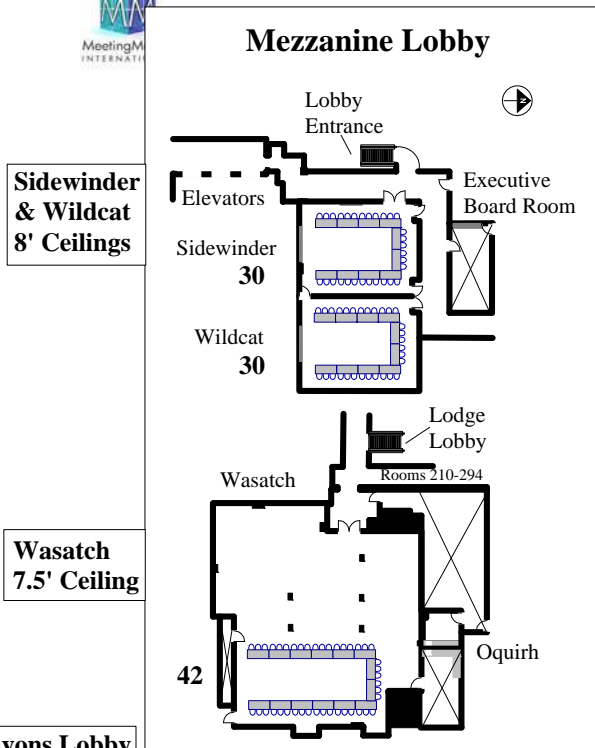

North Star & Orion 8' Ceilings

Alta-Deer Valley 10' Ceilings

Lodge Lobby 10'-12.5' Ceiling

All Ballroom and Meeting Rooms

All Ballroom and Meeting Rooms are capable of accomodating higher occupancy.
Please contact hotel to have a diagram made specifically for your event.



= Restrooms

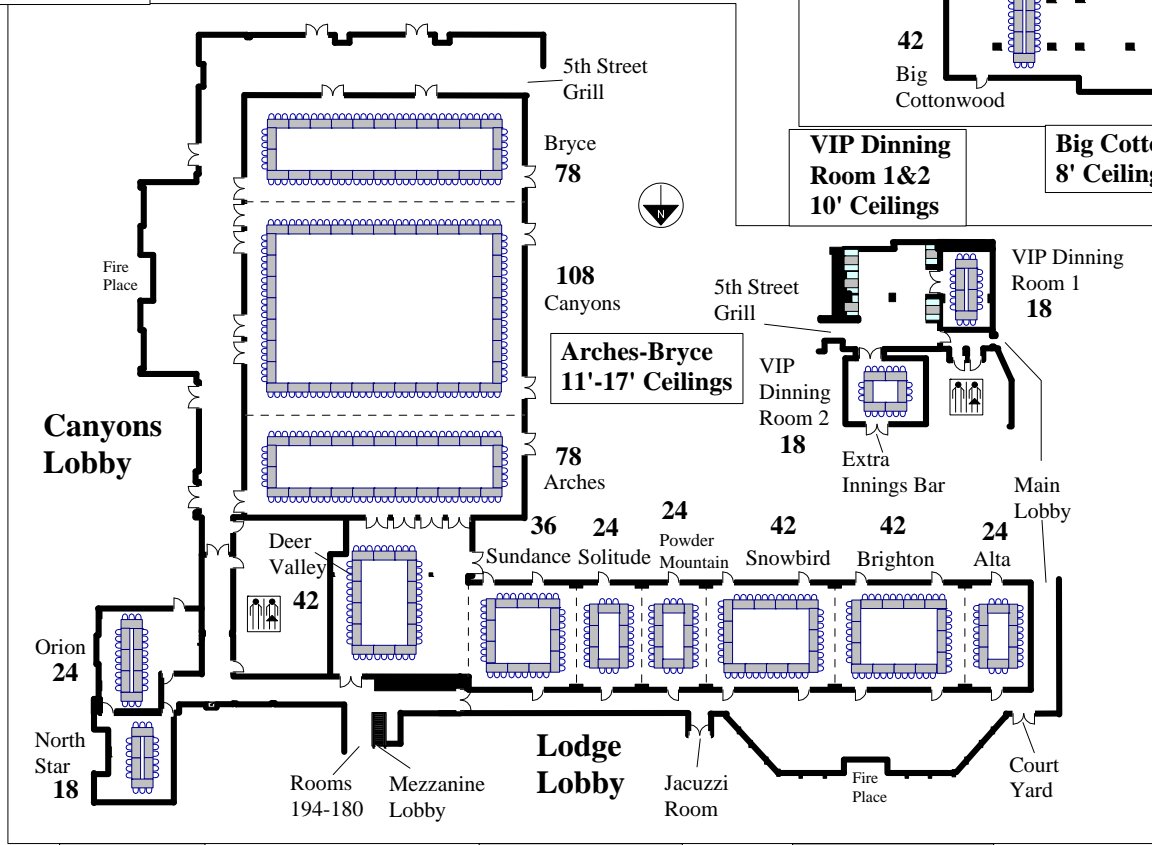
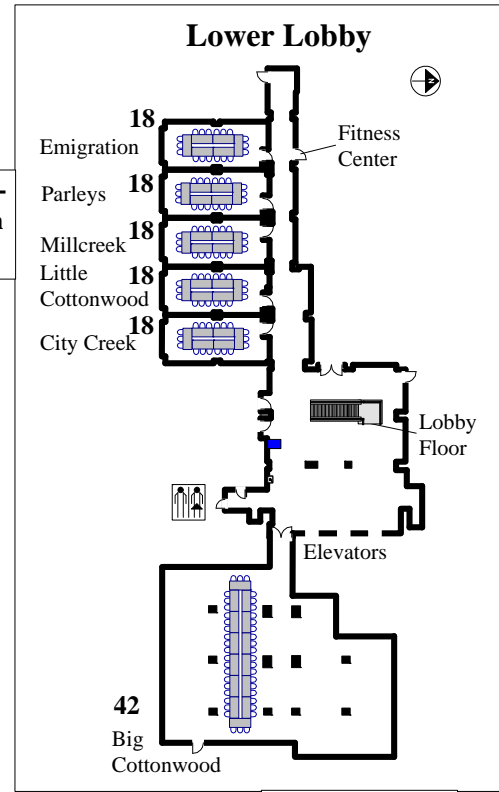
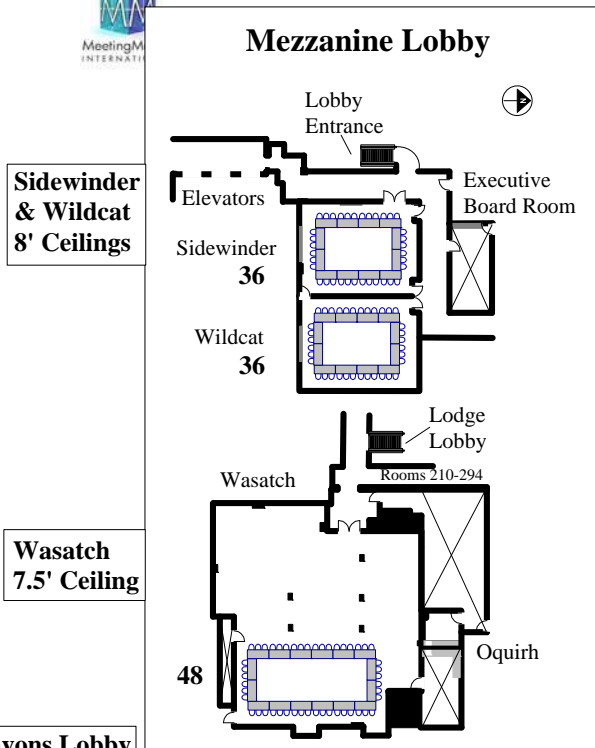

**Sidewinder & Wildcat
8' Ceilings**

**Wasatch
7.5' Ceiling**

**Canyons Lobby
12'-17' Ceiling**

**City Creek-
Emigration
8' Ceilings**

**VIP Dining
Room 1&2
10' Ceilings**

**Big Cottonwood
8' Ceiling**

**North Star
& Orion
8' Ceilings**

**Alta-Deer Valley
10' Ceilings**

**Lodge Lobby
10'-12.5' Ceiling**

All Ballroom and Meeting Rooms

All Ballroom and Meeting Rooms are capable of accomodating higher occupancy.
Please contact hotel to have a diagram made specifically for your event.



= Restrooms

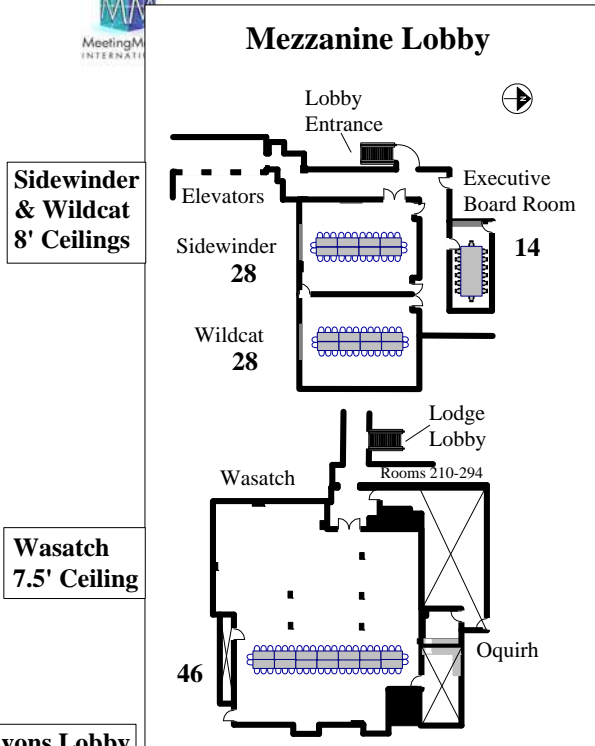

Sidewinder & Wildcat
8' Ceilings

Wasatch
7.5' Ceiling

Canyons Lobby
12'-17' Ceiling

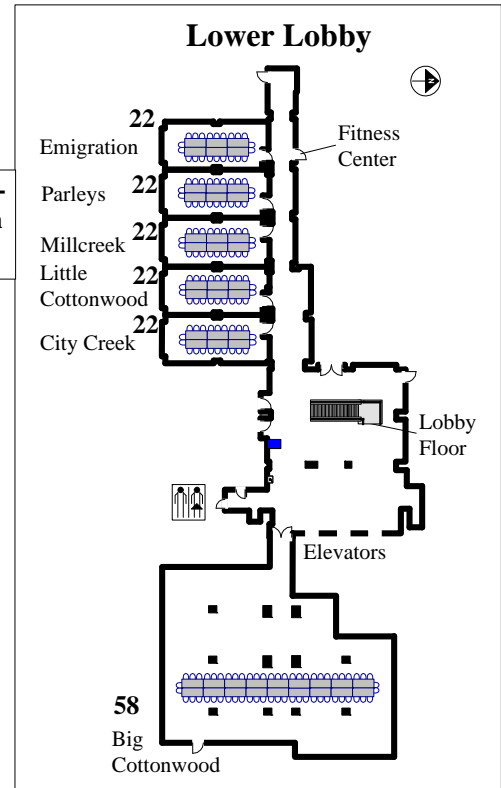

City Creek-Emigration
8' Ceilings

VIP Dining Room 1&2
10' Ceilings

Big Cottonwood
8' Ceiling

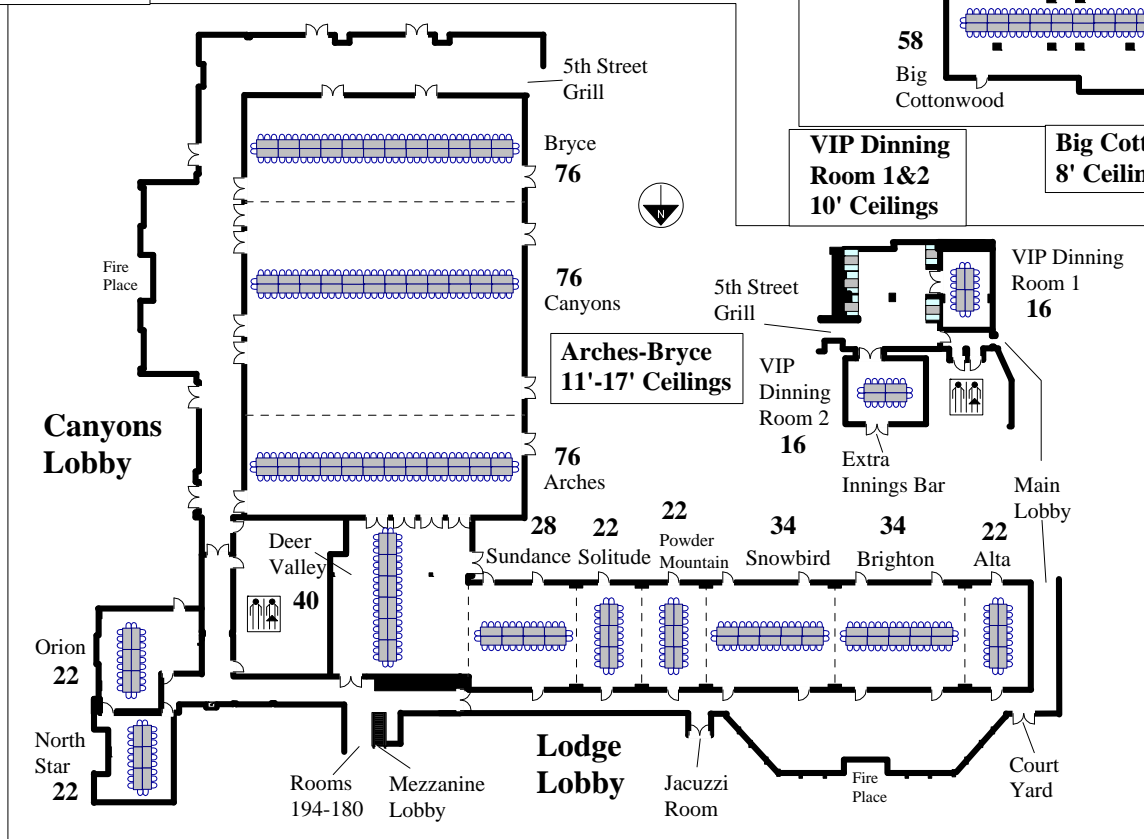

North Star & Orion
8' Ceilings

Alta-Deer Valley
10' Ceilings

Lodge Lobby
10'-12.5' Ceiling

All Ballroom and Meeting Rooms

All Ballroom and Meeting Rooms are capable of accommodating higher occupancy.
Please contact hotel to have a diagram made specifically for your event.



Mezzanine Lobby

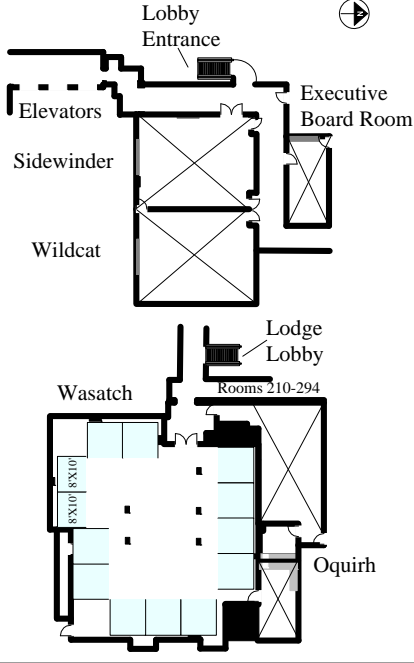

Sidewinder & Wildcat
8' Ceilings

Wasatch
7.5' Ceiling

Canyons Lobby
12'-17' Ceiling

10'X10' Exhibit Booth unless listed otherwise

= Restrooms

Lower Lobby

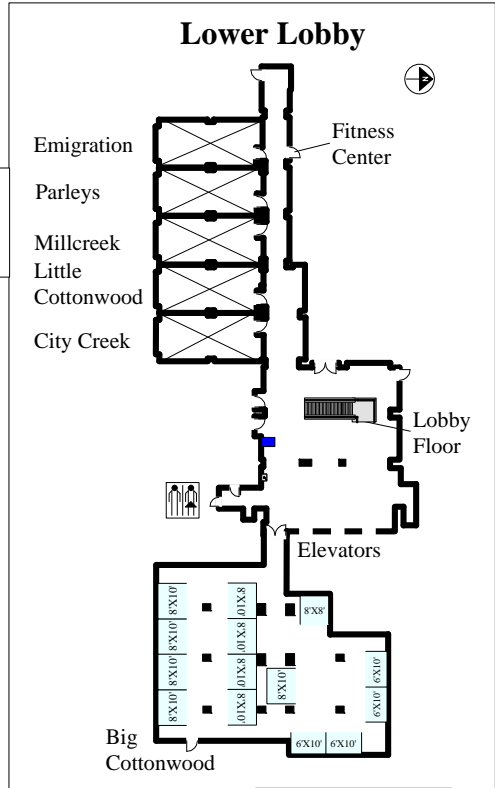

City Creek-Emigration
8' Ceilings

VIP Dining Room 1&2
10' Ceilings

Big Cottonwood
8' Ceiling

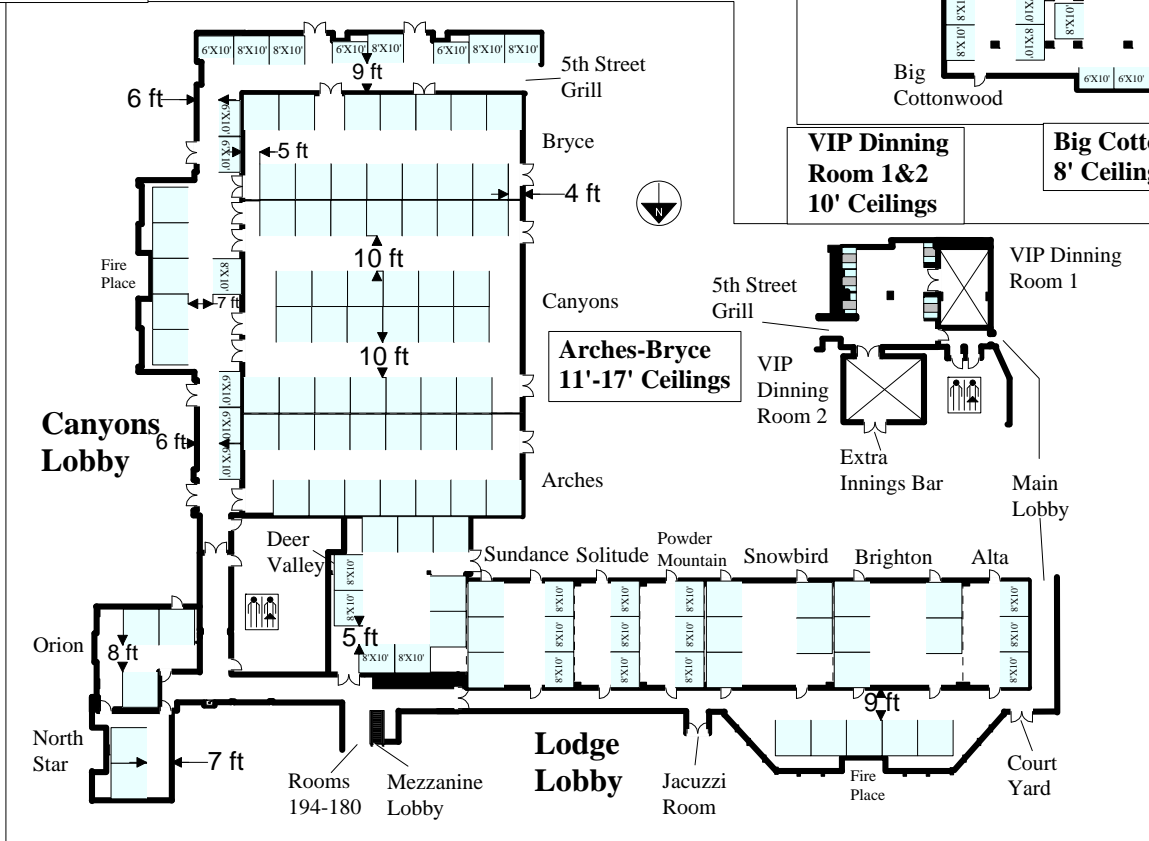

North Star & Orion
8' Ceilings

Alta-Deer Valley
10' Ceilings

Lodge Lobby
10'-12.5' Ceiling