

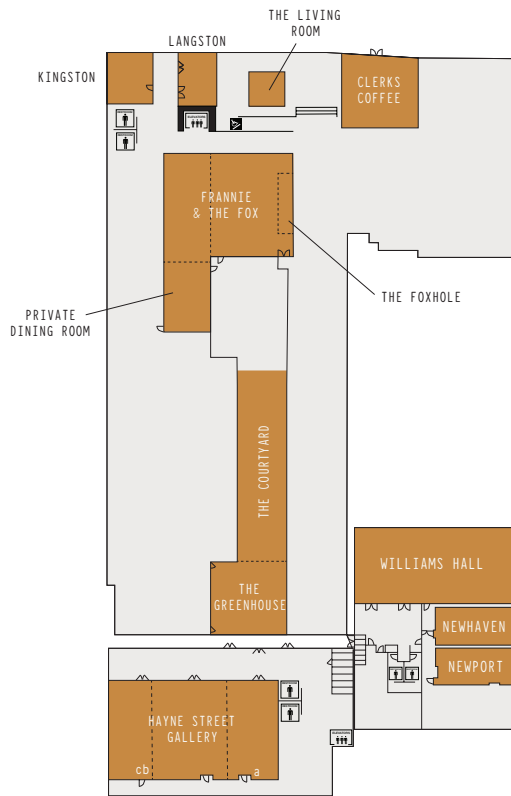

# EMELINE



SCAN FOR A VIRTUAL TOUR



MEETING ROOM	SQ. FT	DIMENSIONS	CEILING	CLASSROOM	U-SHAPE	HOLLOW SQUARE	BOARD	THEATRE	BANQUET	RECEPTION
HAYNE STREET GALLERY	3,354	78' x 43'	18.5'	240	80	85	85	240	240	240
HSG A	1,032	24' x 43'	18.5'	70	25	27	27	75	70	75
HSG B	1,247	29' x 43'	18.5'	90	30	31	31	90	90	90
HSG C	1,075	25' x 43'	18.5'	70	25	27	27	75	70	75
WILLIAMS HALL	2,705	77' x 35'	12'	170	70	78	78	200	170	200
NEWHAVEN	656	36' x 18'	9'	30	18	22	22	55	40	50
NEWPORT	656	36' x 18'	9'	30	18	22	22	55	40	50
KINGSTON	475	23' x 20.5'	9'	20	14	16	16	30	20	30
LANGSTON BOARDROOM	420	24' x 17.5'	9'	18	12	14	14	25	20	25
HANKS SOCIAL HALL	2,140	48' x 44'	22'	100	50	60	60	150	120	150
HANKS LOFT	N/A	N/A'	18'	N/A	N/A	N/A	N/A	150	30	40
THE GREENHOUSE	1,247	36.7' x 34'	8'	N/A	N/A	N/A	N/A	100	70	100
THE COURTYARD (INCLUDING THE GREENHOUSE)	5,267	164.6' x 32'	N/A	N/A	N/A	N/A	N/A	150	120	180



# E M E L I N E

Boasting over 13,000 square feet of new and flexible function space and 10 distinctive event spaces for a variety of group programs from grand receptions to executive board retreats, incentive programs and corporate meetings.

## GUESTROOMS & LUXURY SUITES

212 newly designed guestrooms and suites all offer in-room amenities, contemporary touches and views of historic Charleston or The Courtyard.

### ROOM TYPES

- 68 Standard Guestrooms
- 16 Two King Guestrooms
- 128 Suites

## AMENITIES

- Complimentary Bike Rentals
- Complimentary still and sparkling water station on each corridor
- Complimentary Wi-Fi in guestroom and public spaces
- Valet parking
- Fitness center
- Concierge services
- Turndown service (*upon request*)
- Same day dry cleaning services
- In-room dining
- Honor Bar
- All suites feature a vintage record player and custom-made Emeline record
- Premium Red Flower guestroom amenities

## LOCATION

Nestled on the cobblestone streets in Charleston's historic district, Emeline is located just 30 minutes from Charleston International Airport.

### NEARBY ATTRACTIONS

- Gibbes Museum of Art
- Charleston City Market
- Nathaniel Russell House
- Rainbow Row
- Shops on King Street
- South Carolina Aquarium
- Waterfront Park

## DINING & RETAIL

### KEEP SHOP

Keep Shop, a luxury retail experience located in the lobby of Emeline offers an inventive approach to finding the perfect memory to take with you.

### FRANNIE & THE FOX

Frannie & The Fox is our wood-fired eatery serving American ingredients with Italian sensibilities. Frannie & The Fox offers the perfect setting for the curious traveler — morning, noon or night.

### CLERKS COFFEE COMPANY

Clerks Coffee Company is a down-to-earth, inviting café experience. From coffee to not coffee, Clerks delivers an airy, vibrant setting with a timeless hint of nostalgia.