

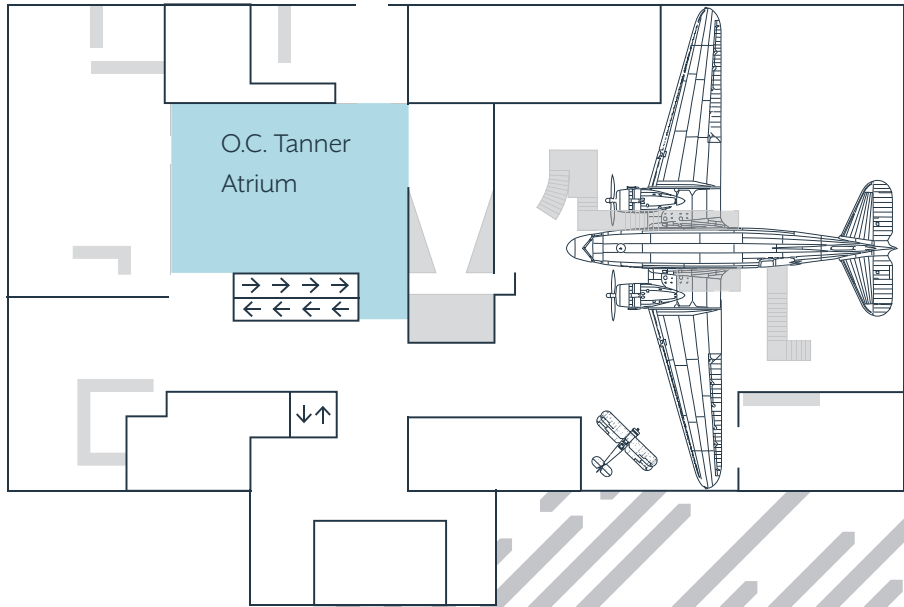

<b>O.C. Tanner Atrium</b>	SIZE	CAPACITY	
	2,000 ft <sup>2</sup>	72 seated	120 reception

Just inside the front doors of The Leonardo is the two-story O.C. Tanner Atrium. The open, easy floorplan allows for a wide range of setups, from evening cocktail hours to large receptions.

Our living, breathing exhibit, The Hylozoic Veil, floats above the space and creates sparkling light for evening events. The O.C. Tanner Atrium also hosts a stunning 27 foot tall mural by renowned Utah artist V. Douglas Snow. This untitled canvas was originally commissioned during the construction of the Salt Lake City Library building in 1964.



MUSEUM of CREATIVITY and INNOVATION

801.531.9800 | [Events@TheLeonardo.org](mailto:Events@TheLeonardo.org) | Event Spaces: O.C. Tanner Atrium



<b>FLIGHT</b>	SIZE	CAPACITY	
	9,800 ft <sup>2</sup>	120 seated	300 reception

Host your event under the belly of our C-131 airplane in The Leonardo's first blockbuster scale exhibit, *FLIGHT*. An open floorplan with unique memorabilia from the history of the Utah aeronautics industry make this inspiring space popular for standing receptions and smaller seated dinners.

*FLIGHT* also includes space in the Curiosity Corner as well as the inside of our real C-131 plane. Add more indoor/outdoor flex space to your event during summer months with the outdoor terrace, accessible from the northeast corner of the exhibit.

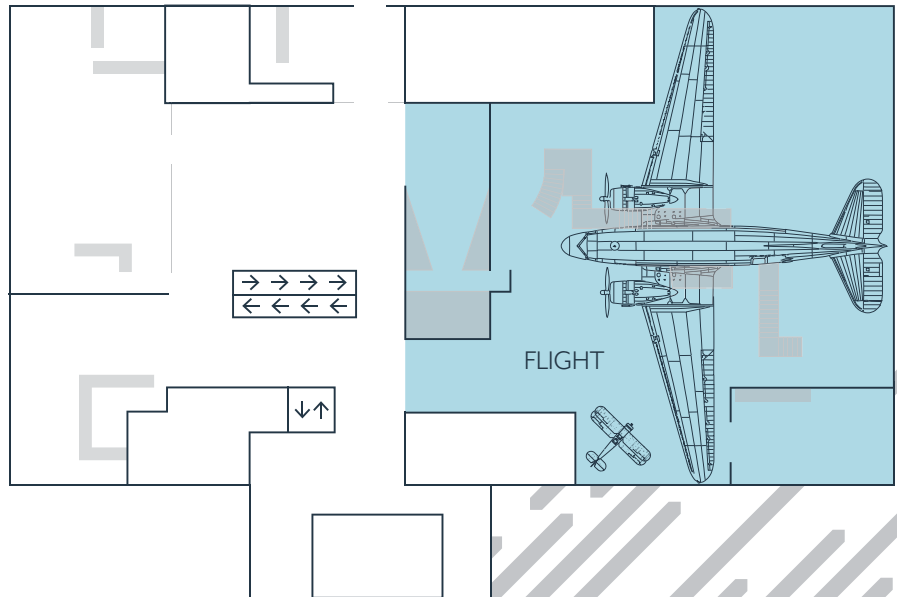

MUSEUM of CREATIVITY and INNOVATION

801.531.9800 | [Events@TheLeonardo.org](mailto:Events@TheLeonardo.org) | **Event Spaces: FLIGHT**





<b>Curiosity Corner</b>	SIZE	CAPACITY	
	675 ft <sup>2</sup>	48 seated	75 reception

Located within FLIGHT is the Curiosity Corner. Boasting two full walls of floor to ceiling windows and a canopy of paper lanterns, this space is a fun and bright backdrop for birthday parties, baby showers, and more. Mood lighting and a dynamic nighttime view of 500 South makes this open space cozy for evening affairs as well.

Curiosity Corner hosts the Flight in Pop Culture wall, a rainbow of flight-themed movie posters. The space also has a long countertop with two stainless steel sinks for easy event preparation and cleanup.

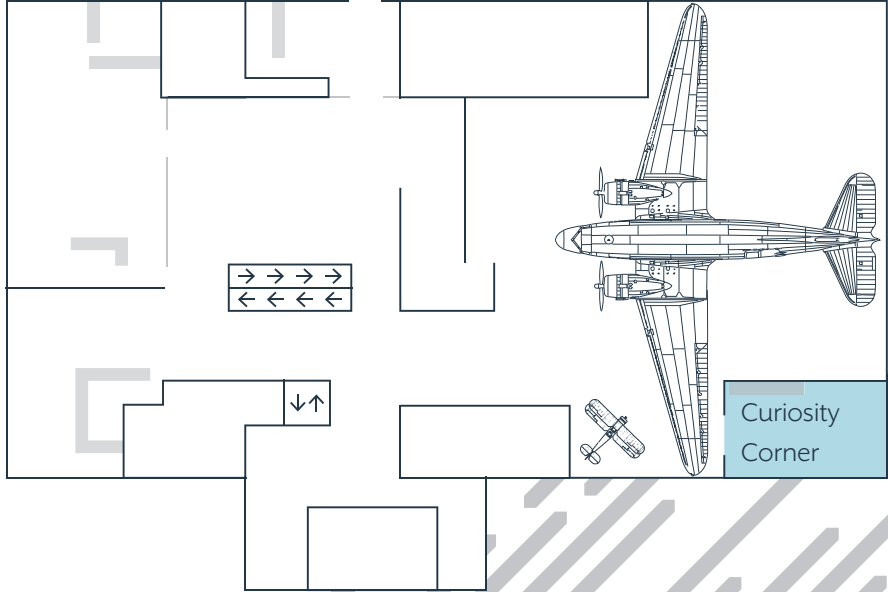

MUSEUM of CREATIVITY and INNOVATION

801.531.9800 | Events@TheLeonardo.org | **Event Spaces: Curiosity Corner**



<b>Terrace</b>	SIZE	CAPACITY	
	6,000 ft <sup>2</sup>	100 seated	200 reception

The Terrace wraps the exterior of the entire FLIGHT exhibit space. This large space is partially enclosed by a waist-high wall running the entire perimeter of the terrace, and can be configured for events of all sizes and layouts.

This outdoor space is a simple addition to events in FLIGHT during warm summer months. Whether it's a reception, birthday party, or shower, the Terrace can do it all.







<b>Human Rights Gallery</b>	<b>SIZE</b>	<b>CAPACITY</b>
	4,000 ft <sup>2</sup>	100 seated / 200 reception

The inspirational Human Rights Gallery is a calm and elegant setting for your event. This gallery hosts exhibits thematically centered around human rights, addressing topics from water rights to children's rights, homelessness, women's equality, and more. This space is airy and has a traditional gallery aesthetic well suited for standing receptions and more intimate parties.

Current exhibit setups provide A/V capabilities in the south end of the space that can be used for your event.

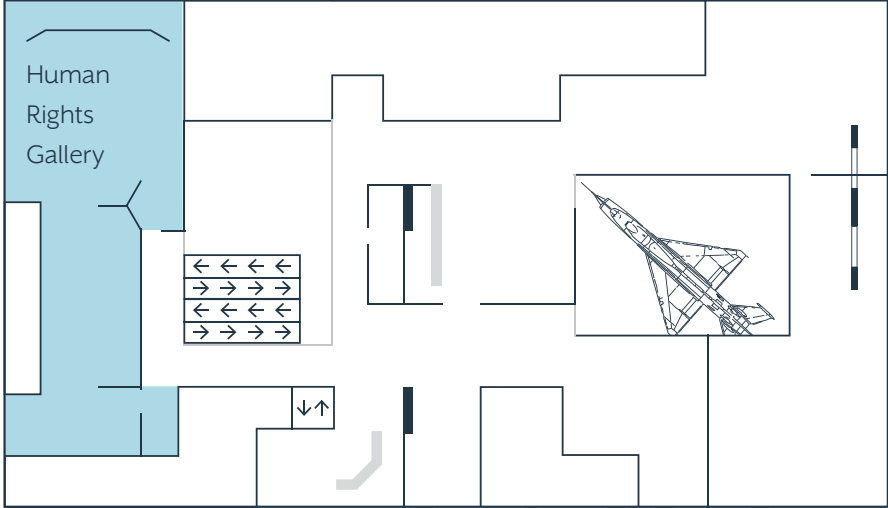

MUSEUM of CREATIVITY and INNOVATION

801.531.9800 | Events@TheLeonardo.org | **Event Spaces: Human Rights Gallery**



<b>James L. Sorenson Family Gallery</b>	SIZE	CAPACITY
	9,900 ft <sup>2</sup>	25 to 300

The James L. Sorenson Family Gallery is our largest single event space, taking up the majority of The Leonardo's second floor. The looped shape of the gallery allows for flexible event sizes and types. By dividing the usage of each exhibit area in the gallery, event hosts can provide their guests with separate spaces for bars, table seating, and standing areas.

Your guests may also access some of The Leonardo's exciting and engaging hands-on exhibits. The second floor balconies allow up close and personal views of Hylozoic Veil in the Atrium and our MiG-21 fighter jet in FLIGHT.

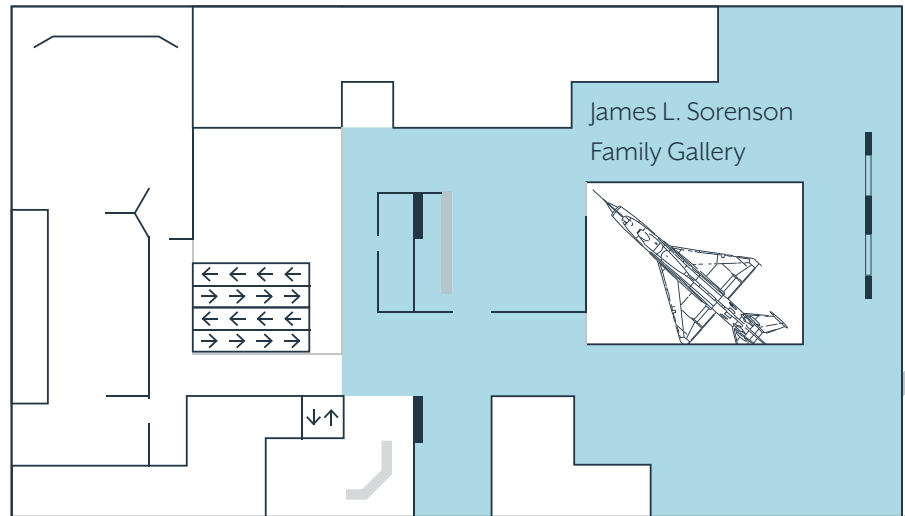

MUSEUM of CREATIVITY and INNOVATION

801.531.9800 | [Events@TheLeonardo.org](mailto:Events@TheLeonardo.org) | Event Spaces: James L. Sorenson Family Gallery





<b>Sorenson Event Center</b>	SIZE	CAPACITY	
	4,000 ft <sup>2</sup>	240 seated	350 reception

Enjoy sweeping views of the Salt Lake Valley, City and County Building, the Salt Lake Library, and downtown from our third floor Event Center. This space has hosted many diverse events, including wedding ceremonies and receptions, dance parties, business luncheons, speeches, small conventions, holiday parties, and more.

The Sorenson Event Center is conveniently located by The Leonardo's auditorium for even more event flexibility. For fair weather events, the space opens into our courtyard for extra square footage and refreshing breezes.

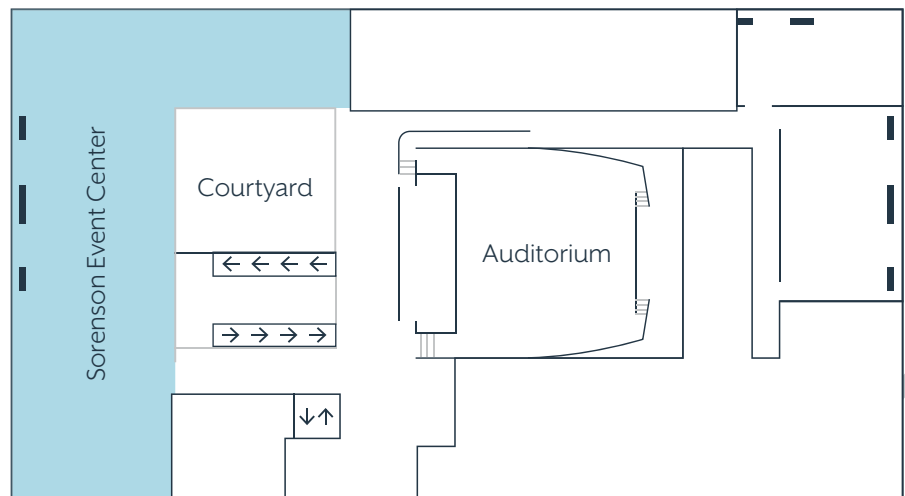

MUSEUM of CREATIVITY and INNOVATION

801.531.9800 | [Events@TheLeonardo.org](mailto:Events@TheLeonardo.org) | **Event Spaces: Sorenson Event Center**



<b>Outdoor Courtyard</b>	<b>SIZE</b>	<b>CAPACITY</b>	
	1,100 ft <sup>2</sup>	25 seated	40 reception

The unique outdoor courtyard is an excellent additional space to add onto fair weather events in the auditorium or event center. The fully collapsible glass walls into the event center are customizable and create unique indoor-outdoor space for your event. The courtyard also has easy access to the auditorium hallway.

A one-of-a-kind bronze sculpture by the late renowned artist Angelo Caravaglia decorates the courtyard along with a trio of landscaped planter boxes.

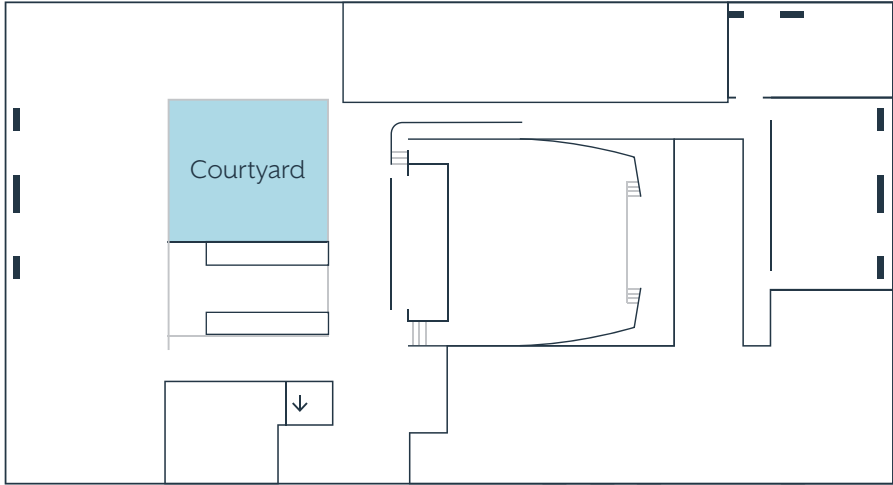

MUSEUM of CREATIVITY and INNOVATION

801.531.9800 | [Events@TheLeonardo.org](mailto:Events@TheLeonardo.org) | **Event Spaces: Outdoor Courtyard**





<h1>Auditorium</h1>	<b>SIZE</b> 1,720 ft <sup>2</sup>	<b>CAPACITY</b> 198 seated
---------------------	--------------------------------------	----------------------------------

Host presentations, business retreats, and movie screenings in our auditorium. It boasts comfortable seating for 198, full A/V capabilities, and a large matching podium.

Open space below the stage allows for table setup or space to mingle before or after events. The auditorium is easily catered to for breakfast or lunch in the hallway immediately outside its doors. Space in the hallway can accommodate table setup for check-in areas. The auditorium is conveniently located next to the Event Center and third floor Courtyard.

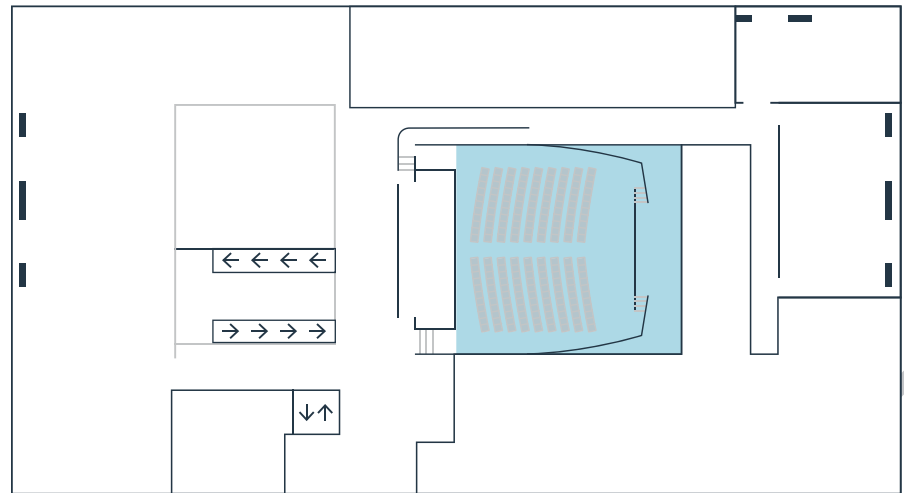

MUSEUM of CREATIVITY and INNOVATION

801.531.9800 | [Events@TheLeonardo.org](mailto:Events@TheLeonardo.org) | **Event Spaces: Auditorium**



<h1>Boardroom</h1>	SIZE	CAPACITY	
	590 ft <sup>2</sup>	14 seated	40 reception

Enjoy beautiful views of the Wasatch range and The University of Utah in The Leonardo boardroom. The boardroom is an excellent choice for meetings, retreats, presentations, and lunches. The boardroom is a convenient choice for events requiring multiple rooms when booked in conjunction with the neighboring East Classroom.

This room includes our custom board table and chairs and full A/V capabilities. The boardroom can easily be set up for catering during your event. This space is also frequently used as a green room for entertainment from the Event Center.

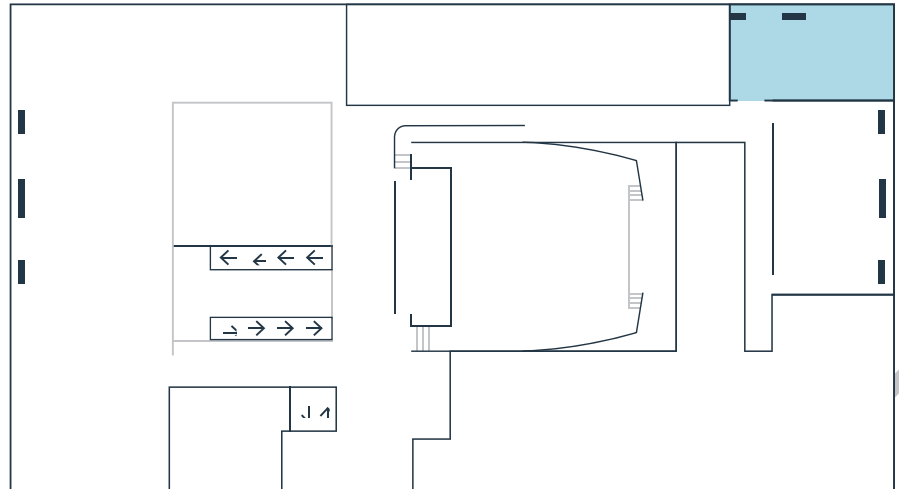

MUSEUM of CREATIVITY and INNOVATION

801.531.9800 | Events@TheLeonardo.org | Event Spaces:Boardroom





<b>East Classroom</b>	<b>SIZE</b>	<b>CAPACITY</b>	
	990 ft <sup>2</sup>	30 seated	40 reception

Sweeping mountain views and large windows are only one perk of the East Classroom. Whiteboard space, work tables and chairs, and a flexible floor plan make this space an excellent choice for business retreats, seminars, or workshops.

As a part of the Micron Education Center, this classroom is immediately adjacent to the boardroom and is an excellent choice for events with multiple concurrent activities.

A full wall run of counters and two sinks are another helpful addition to this classroom.

